

• CHEVROLET MOTOR DIVISION, GMC •				UPC	DATE	SYM	REVISION RECORD	AUTH.	DR	CK
AIR CONDITIONING-CONTROL SYSTEM & WIRING DIAGRAM MOD 12000 DWG 3-14 FM REF: Prel. L-79587 L-79304 DATE REL 4-12 DP L- L-				C60 E8 X SHEET	7-6-66	1	REDRAWN & REDESIGNED	73021	FM	DP
					2-1-67	2	BLOWER SWITCH DWG RMD	84670	RA	
						3	WIRES 16Y & 14BRN REMOVED			
						4	14BRN WAS 16Y & DWG REVISED			CI

1 2977253 CONNECTOR

5

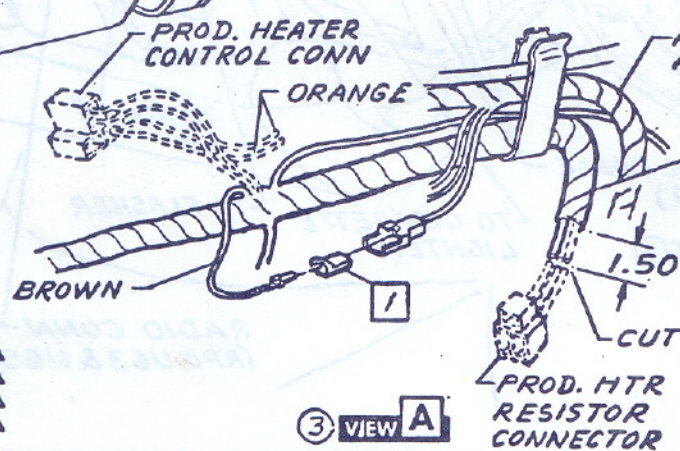
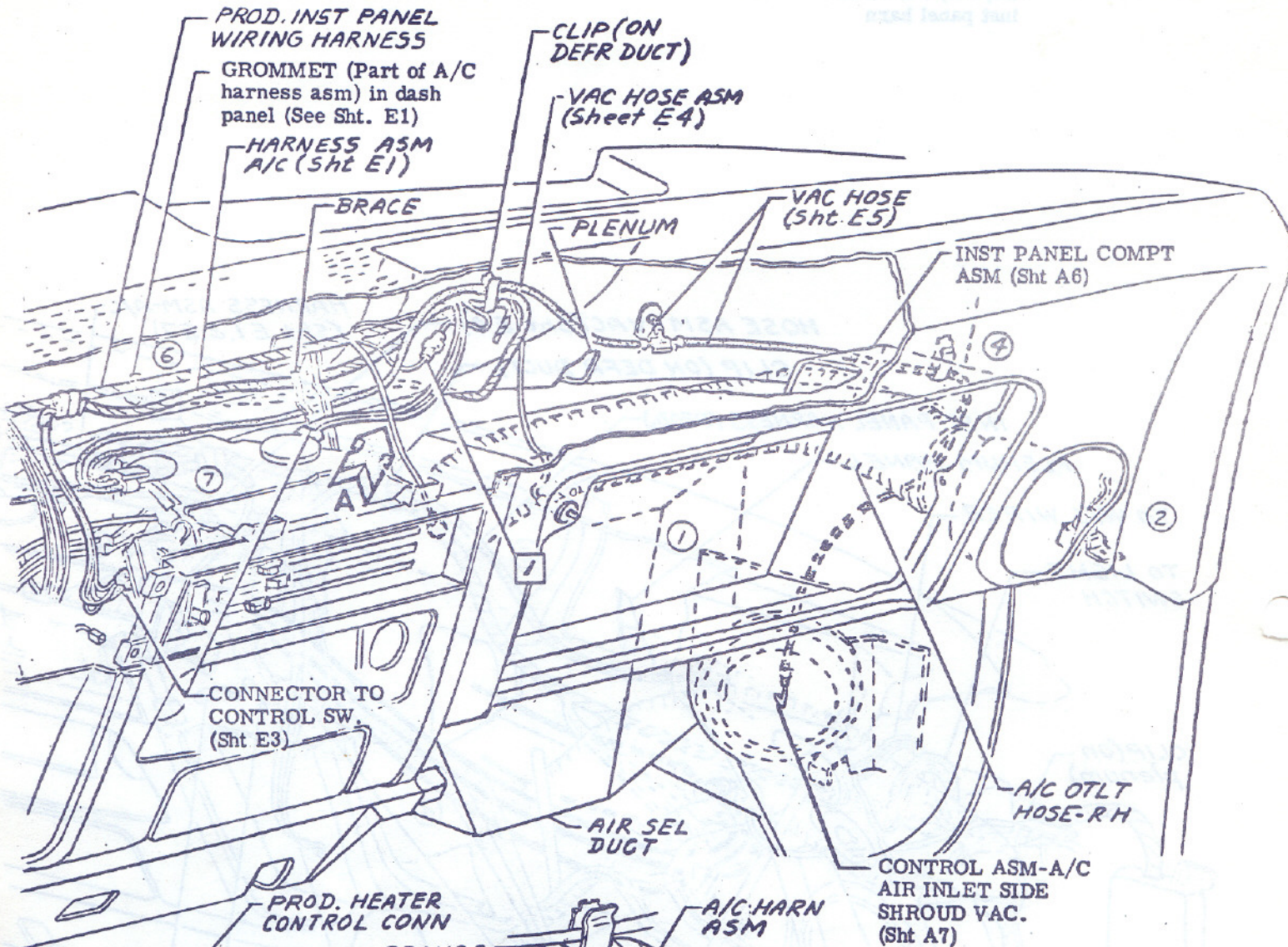

- NOTE** Rework prod. Inst Pnl Harness:
1. Cut heater resistor leads 1.50 inches before breakout & discard the conn.
 2. Remove terminal (brown wire) from prod. heater switch conn & insert into **1**.
 3. Cut the (2) heater control conn orange leads flush at breakout.
 4. Pull heater control connector (& four wires) free from harness & discard.

3 **VIEW A**

• CHEVROLET MOTOR DIVISION, GMC •

UPC DATE SYM REVISION RECORD AUTHL DR CK

TITLE		UPC	DATE	SYM	REVISION RECORD	AUTHL	DR	CK	
AIR CONDITIONING-INST PANEL WIRING		C60	5-9-66	1	VAC HOSES REROUTED	77265	FM		
				2	DR SW WRG REMOVED	73021		DF	
			7-6-66	3	VIEW A REVISED	80094	FM		
				4	VAC HOSE REROUTED				
				5	3724851 TAPE REMOVED	73021			
				6	A/C HARN REROUTED				DP
				7	WIRE & SWITCH DWG REMOVED	54670	PA	CI	
MOD 12000-		E7							
DWG FILE: L-1-31 FM REF: Prel. E7 L-77753 L-80356									
DATE ECL. 3-1 WFB L- L- L-									
		SHEET X							

511 3724851

TAPE (4 in.)
Tape A/C harness to
inst panel harness

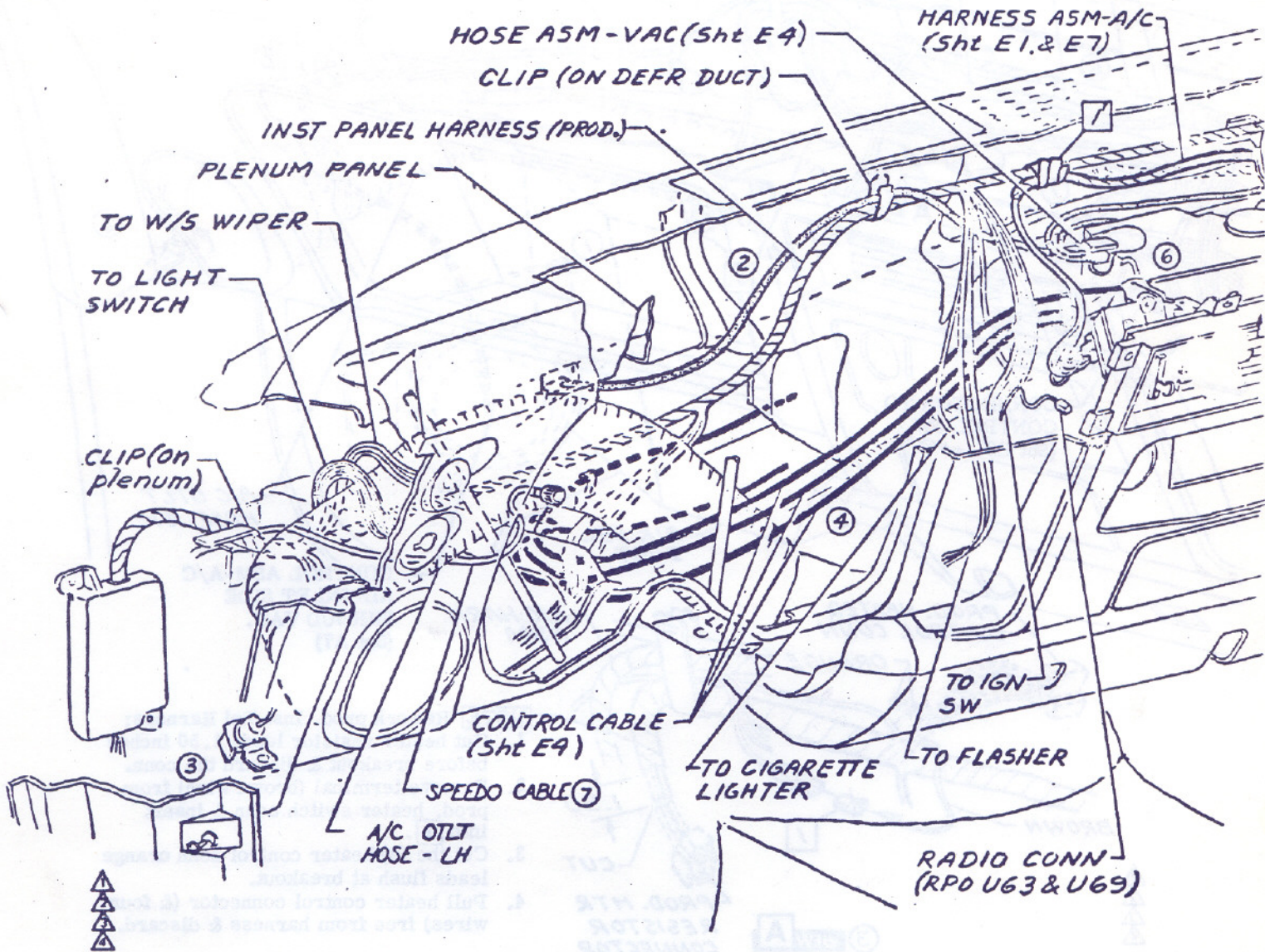

• CHEVROLET MOTOR DIVISION, GMC •		UPC	DATE	SYM	REVISION RECORD	AUTH.	DR	CK	
TITLE	AIR CONDITIONING-INST PANEL WIRING		C60	5-9-66	1	120114 FUSE REMOVED	77605	FM	
					2	VAC HOSE ASM REROUTED	77020		
					3	DR SW WRG REMOVED	73021		
					4	CONT CABLES REROUTED	71630		LF
MOD	12000		E6	6-30-66	5	ITEM 1 ADDED	73021	FM	WEB
				2-1-67	6	WIRE & SWITCH DWG REMOVED	84670	PA	CI
				3-22-67	7	CABLE DWG. ADDED	85630	RT	CI
DWG PREL 1-28 FM REF: Prel. E6 L-80356L-77753		DATE REL. 3-1 WEB L- L- L-		X SHEET					

- | | | |
|-----------------|--------------------|--------------------|
| 1 3895904 TEE | 3 3839654 HOSE-VAC | 6 3895905 HOSE-VAC |
| 2 3891759 CLAMP | 4 _____ | 7 3841230 SCREW |
| | 5 3895903 GROMMET | |

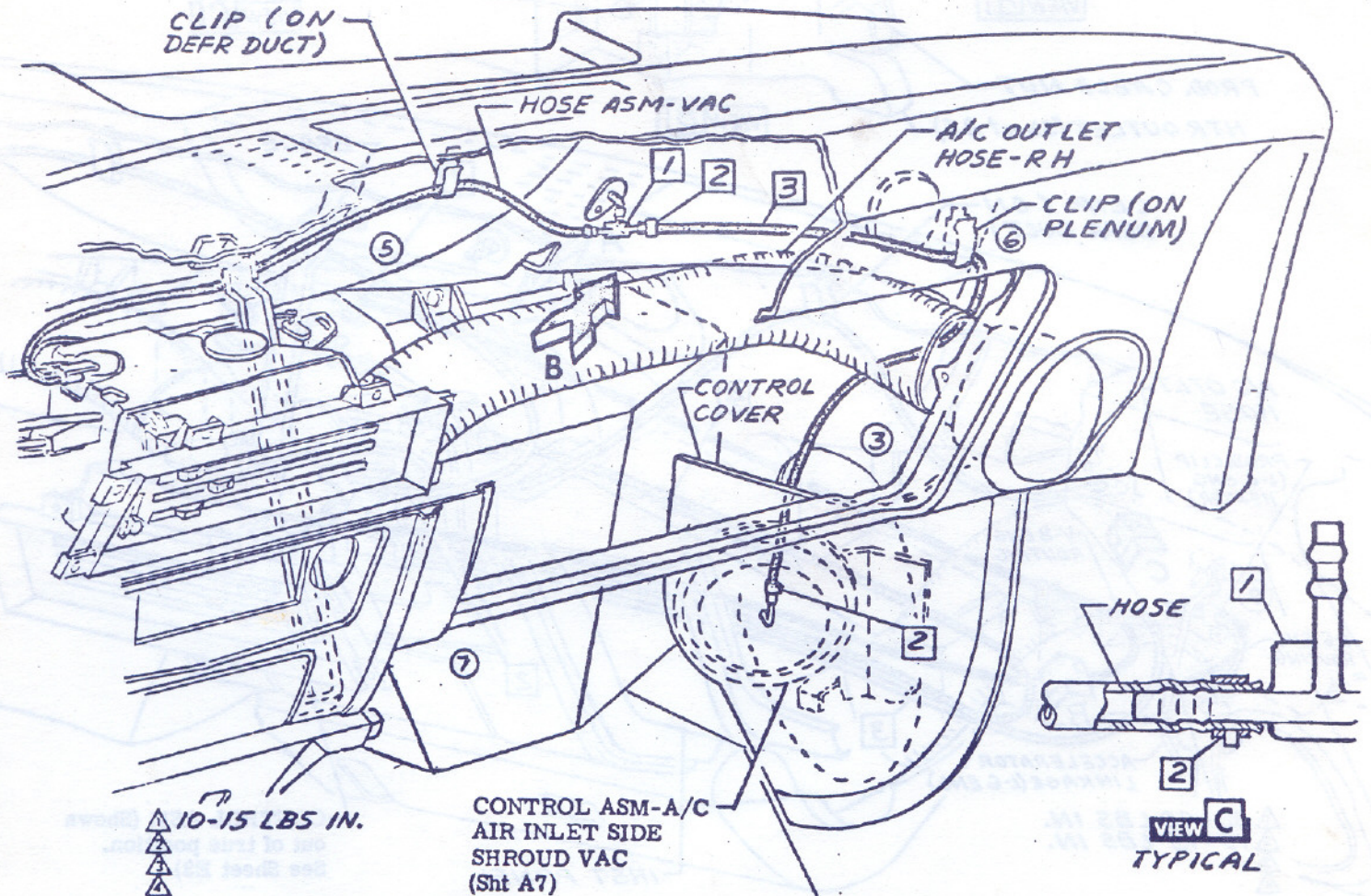
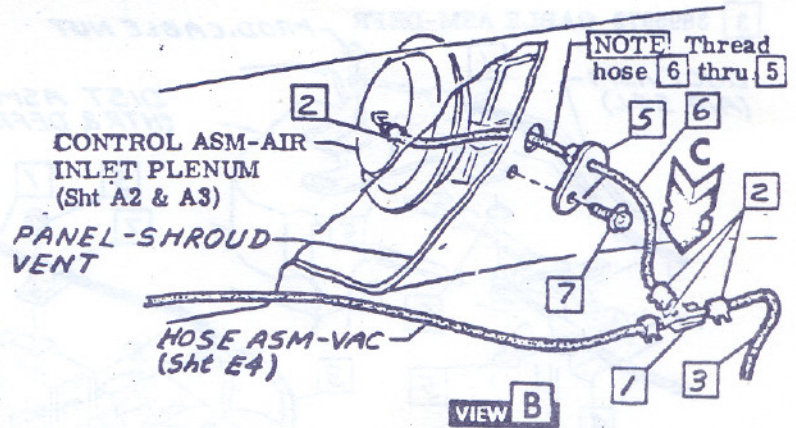

• CHEVROLET MOTOR DIVISION, GMC •

UPC

DATE SYM

REVISION RECORD

AUTH. DR CK

TITLE
AIR CONDITIONING-VACUUM CONTROL HOSES

C60

DATE	SYM	REVISION RECORD	AUTH.	DR	CK
5-4-66	1	WAS 3828748 HOSE	77265	FM	
	2	2399080 CLAMP REMOVED			
	3	VAC HOSE REROUTED			
	4	VIEW A REMOVED			
	5	VAC HOSE ASM REROUTED	77020	DF	
6-30-66	6	HOSE Routed THRU CLIP	80094	FM	
	7	DUCT REVISED	76679	WBB	

MOD 12000

E5

U.S.G. PREL-1-25 FM REF: Prel. E5 L-80356 L-80412
LATE REL 3-1 WRS L-80866 L-

SHEET 1

- (8) 1 3917368 CABLE ASM-TEMP (L-6 ENG)
- (10) 2 3917386 (V-8 ENGINE)
- (11) 3 3919555 HOSE ASM-VAC
- 4 3895972 CABLE ASM-DEFR
- 5 3895974 CABLE ASM (OTLTS)
- 6 PROD. SCREW (HTR CABLE)
- 7 381700 CABLE NUT
- 8 PROD. CLIP (HTR AIR CABLE)
- 9 3895903 GROMMET
- 10 3841230 SCREW

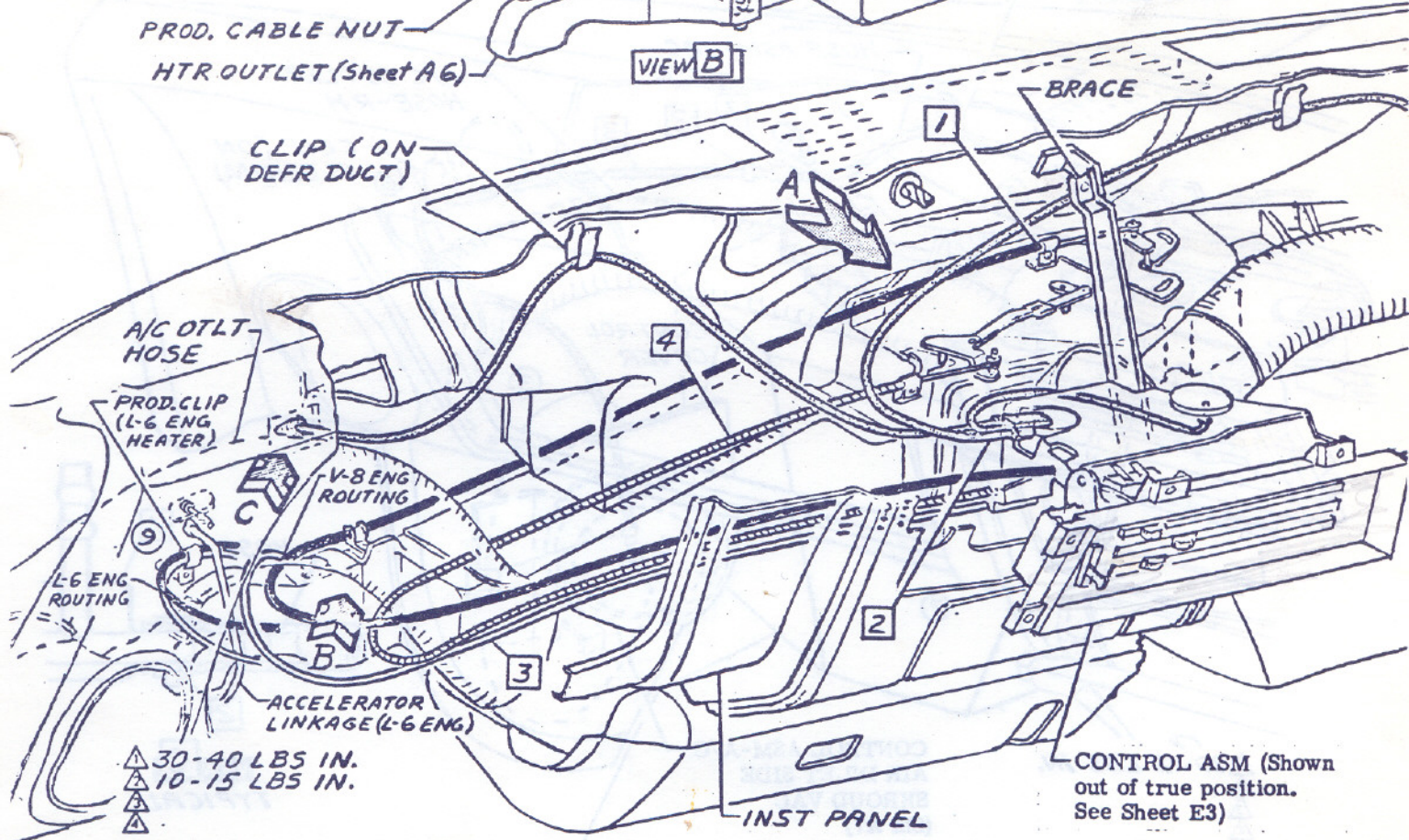
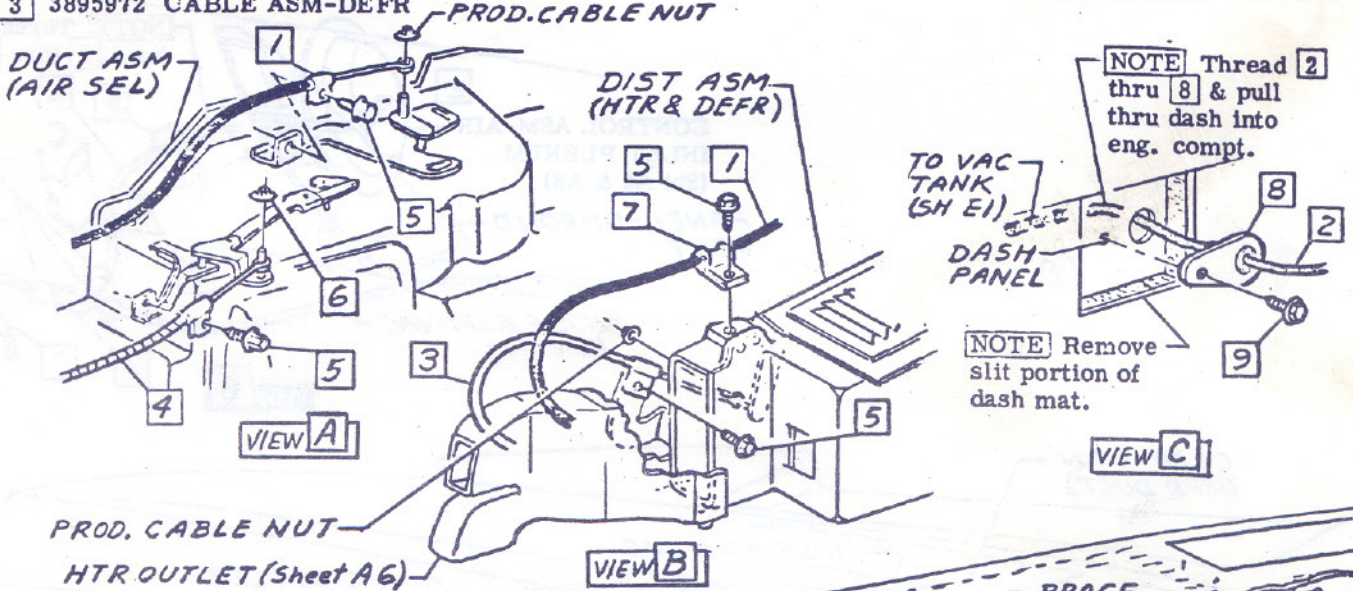

CHEVROLET MOTOR DIVISION, GMC				UPC	DATE	SYM	REVISION RECORD	AUTH	DR	CK
AIR CONDITIONING-CONTROL CABLES & VACUUM HOSE ASM 12000 DWG PREL-1-21 FM REF: Prel. E4 L-80356 L-80866 DATE: PCL. 3-1 C1 L- L- L-				C60 E4 <input checked="" type="checkbox"/> SHEET	1/28/66	8	3917368 WAS 3895973	82562	FM	
						9	L-6 ENG CABLE ROUTING ADDED			
					12-16-66	11	3917386 WAS 3895973 WAS 3895981 HOSE	83812	DE	
							83724	RA	CI	



CHEVROLET

ASSEMBLY INSTRUCTIONS

3891775 "F" CAR 12000 SERIES

- 1 1998874 SWITCH ASM
- 2 3891797 CONTROL ASM
- 3 PROD. SCREW (HTR CONT)
- 4 9420494 SCREW
- 5 3891795 SWITCH ASM
- 6
- 7 PROD. SCREW (HTR CABLE)
- 8 PROD. CABLE NUT (HTR)
- 9 3891759 CLAMP

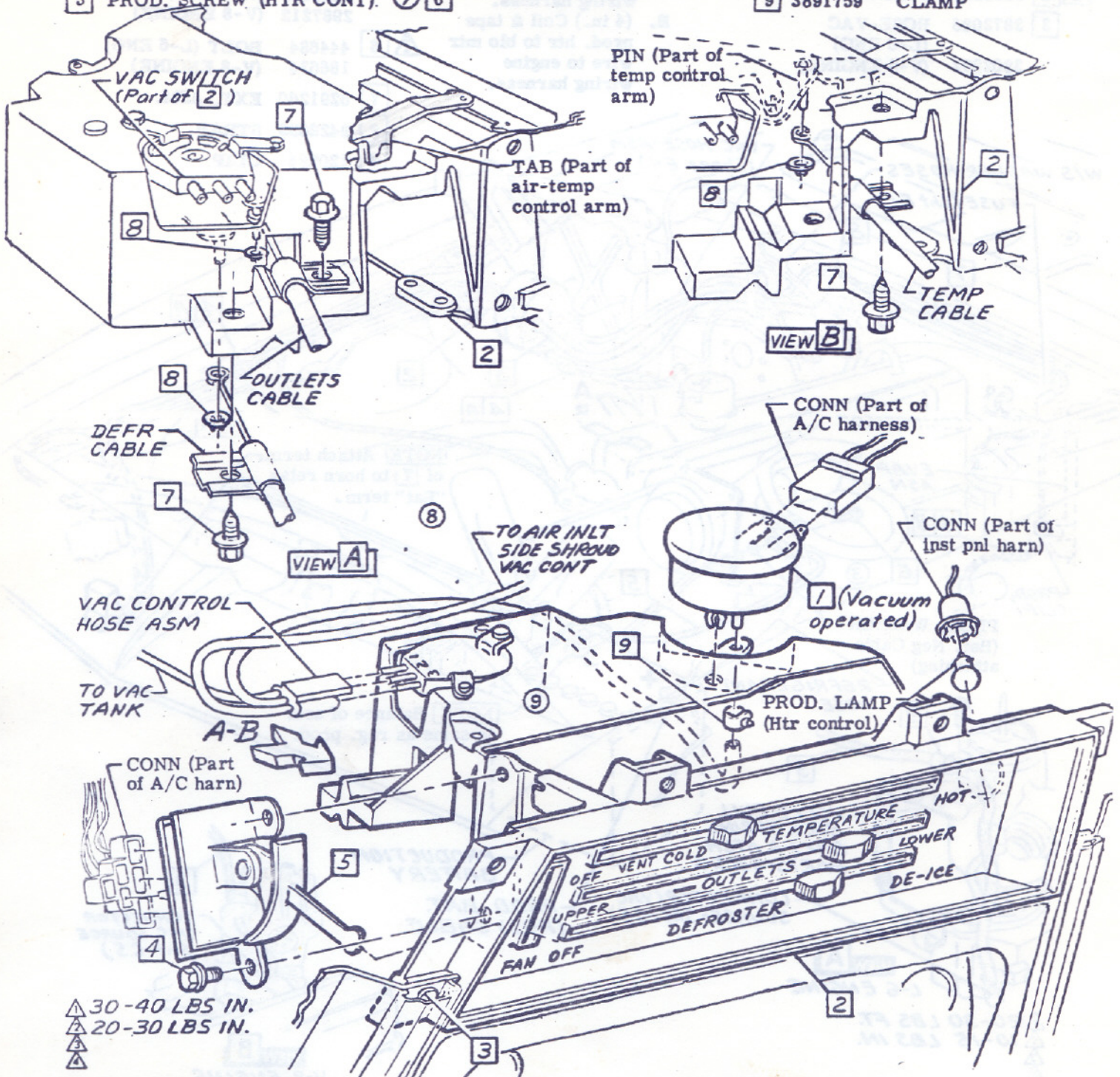

▲ 30-40 LBS IN.
 ▲ 20-30 LBS IN.
 ▲

CHEVROLET MOTOR DIVISION, GMC		UPC	DATE	SYM	REVISION RECORD	AUTH	DR	CK
AIR CONDITIONING-CONTROL ASM		C60	2-1-67	7	3891796 SWITCH REMOVED	89670	RA	
				8	SCREW DRAWING REMOVED			
12000		E3			9	CONNECTOR DRAWING REMOVED		CI
JNG:PREL 1-18 FM REF: Prel. E3 L-79587 L-80412		SHEET						
DATE REL. 3-1 CI L- L- L-								



- 1 385075 TANK ASM
385076 (OPT)
- 2 3866153 SCREW
- 3 3872086 HOSE-VAC
(L-6 ENG)
3902292 (V-8 ENGINE)
- 4 3724851 TAPE
A. (4 in.) Tape 7 to
gen & fwd lamp
wiring harness.
B. (4 in.) Coil & tape
prod. htr to blo mtr
wire to engine
wiring harness.
- 5 2987251 CABLE ASM-BAT
NEG (L-6 ENG.
EXC RPO L22)
6286125 (RPO L22)
2987212 (V-8 ENGINE)
- 6 444684 BOLT (L-6 ENG)
186634 (V-8 ENGINE)
- 7 6291260 EXT. ASM.
- 8 9422033 STRAP
- 9 120524 CLIP

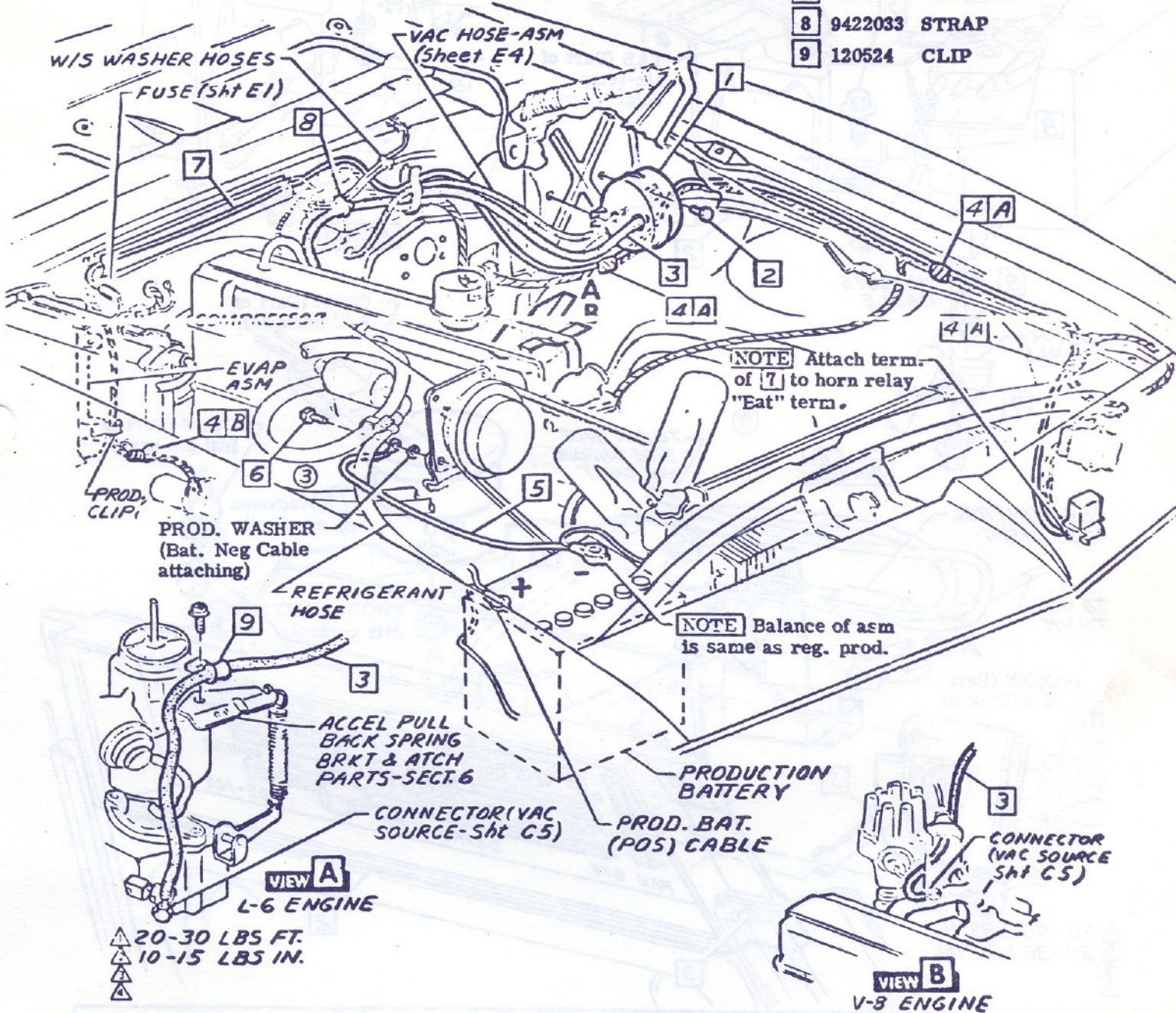

• CHEVROLET MOTOR DIVISION, GMC •		UPC	DATE	SYM	REVISION RECORD	AUTH	DR	CR
AIR CONDITIONING-BATTERY CABLES & VACUUM TANK		C60 E2	6-30-66	2	REDRAWN & REDESIGNED	80610	FM	
					75712 75604 75404 75370	73021	WES	
MOD 12000 DWG PREL 1-12 FM REF: Prel. E2 L-77753 L-81461 DATE REL. 3-1 WMM L-80356 L-83255 L-		E2	11-1-66	3	BAT. GRD CABLE REROUTED	82297	FM	DF

- ▲ 1 3873950 SCREW
- 2 3843404 SEAL
- ⊕ 3 3883843 RESISTOR ASM
- 4 3883844 GASKET

- 5 1116992 RELAY ASM
- 6 6290626 HARNESS ASM-A/C
- ▲ 7 9420415 SCREW
- 8 3724851 TAPE (4 in.) (V-8 ENG) Coil & tape excess harn compressor leads.
- ③ 9 9426331 FUSE
- 10 174916 L. WASHER (Exc RPO U63, U69)

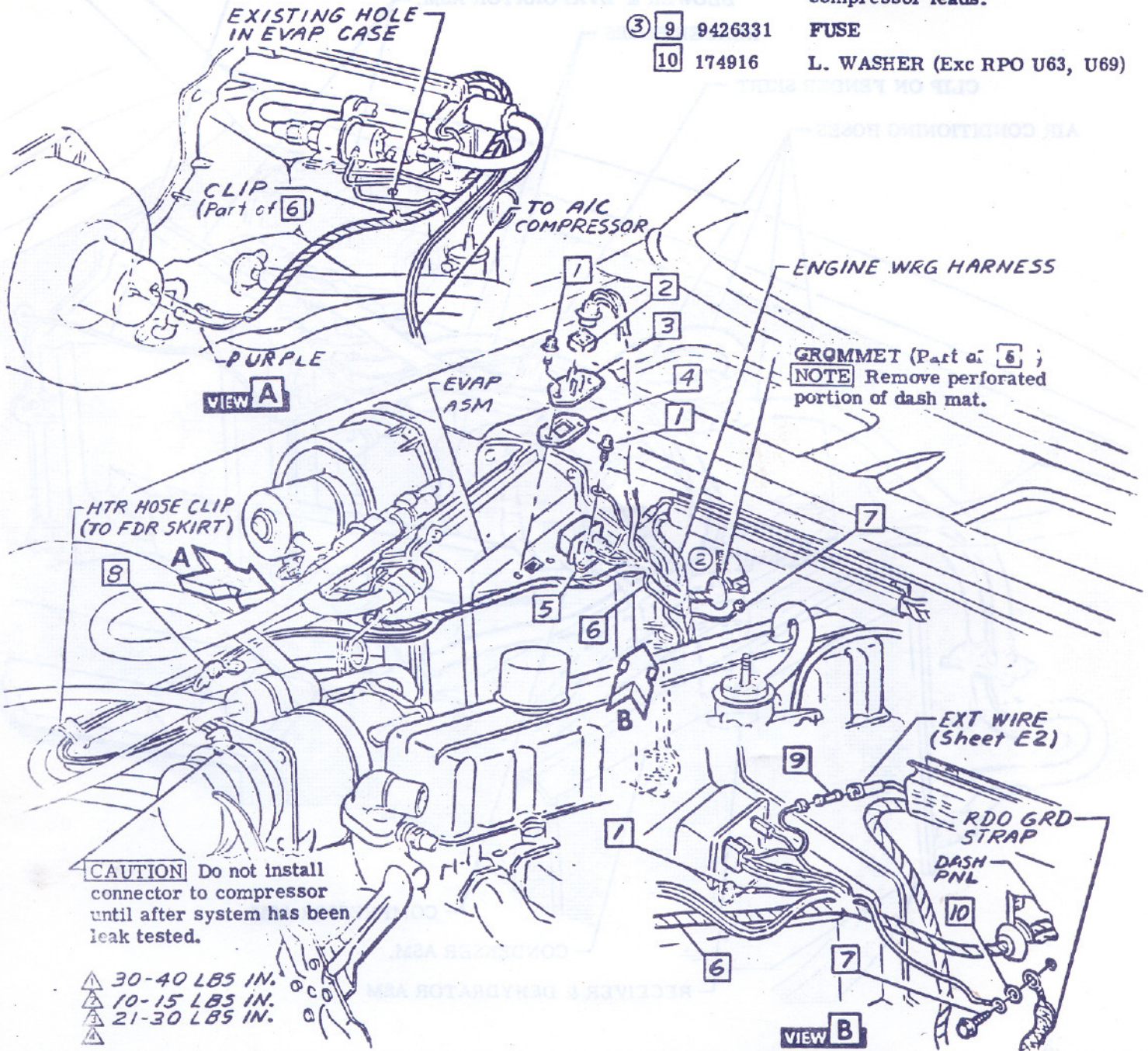

● CHEVROLET MOTOR DIVISION, GMC ●		UPC	DATE	SYM	REVISION RECORD	AUTH	DR	CK
AIR CONDITIONING-FRONT WIRING		C60	4-25-66	1	REDRAWN & REDESIGNED 73021	77020	FM	
MOD 12000								
DWG PREL 12-14 FM REF: Prel. E1 L-79691 L-80356		E1	6-22-66	2	ENG WRG HARN REROUTED	80094	FM	WRC
DATE REL. 3-1 WEA L-77753 L-81691 L-78001				11-1-66	3	WAS 120114 FUSE	81658	FM
		SHEET X	1-29-66	4	WAS 3899763 RESISTOR	82986	FM	RF

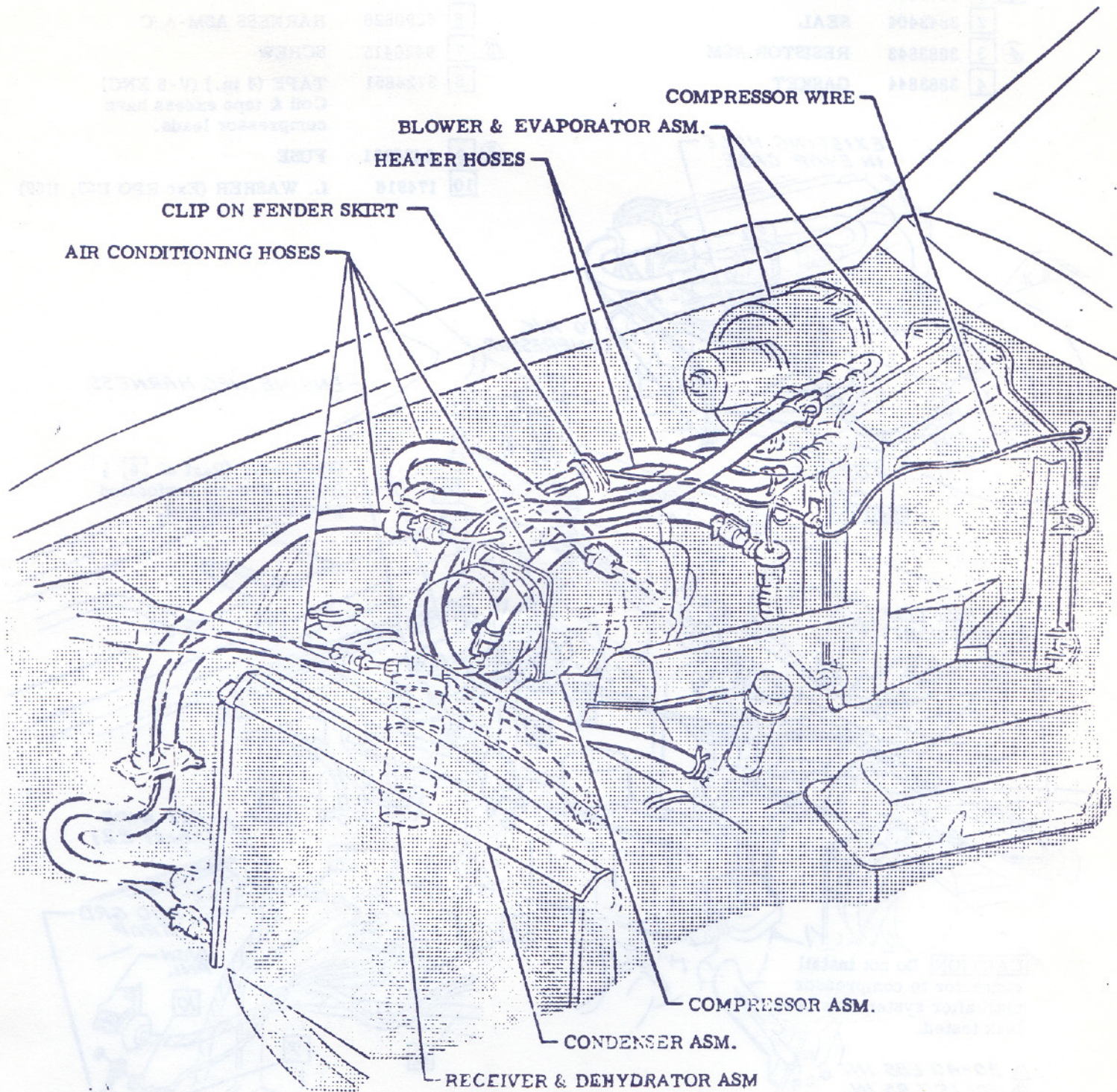

CHEVROLET MOTOR DIVISION, GMC

UPC

DATE SYM

REVISION RECORD

AUTH DR CK

HOSE ROUTING-HEATER & A/C

C60

6-29-66 | HOSE ROUTING REVISED 76130 78849 BM/WEB

MOD 12000 L. D.

D5

DWG PREL. 1-28 ^{DAY} REF: Prel. D4 L-81387 L-79691
 DATE REL. 3-1 WEB L- L- L-

SHEET X

- 1 3752052 HOSE-WATER PUMP V-8 ENG
- 3754190 L-6 ENG.
- 2 3902328 HOSE-INLET MANIFOLD
- 3 181610 BOLT
- 4 187119 L. WASHER
- 5 103320 L. WASHER
- ① 6 120368 NUT
- 7 3849848 NIPPLE
- 8 3853968 CLIP
- 9 180129 BOLT
- ⑥ ② 10 9422277 NUT
- 11 3895993 HOSE-THERMO. HOUSING
- 12 3851320 CLIP
- 13 186634 BOLT
- 14 3885184 GROMMET

- ③ 15 3873950 SCREW
- 16 This hose must route over water pump hose at all times.
- ⑧ ⑦ 17 3767476 PLUG-SPL.

⑨ **NOTE** Hose slack must be positioned rearward of prod. clip prior to securing clip to fender.

⑩ PROD. CLIP

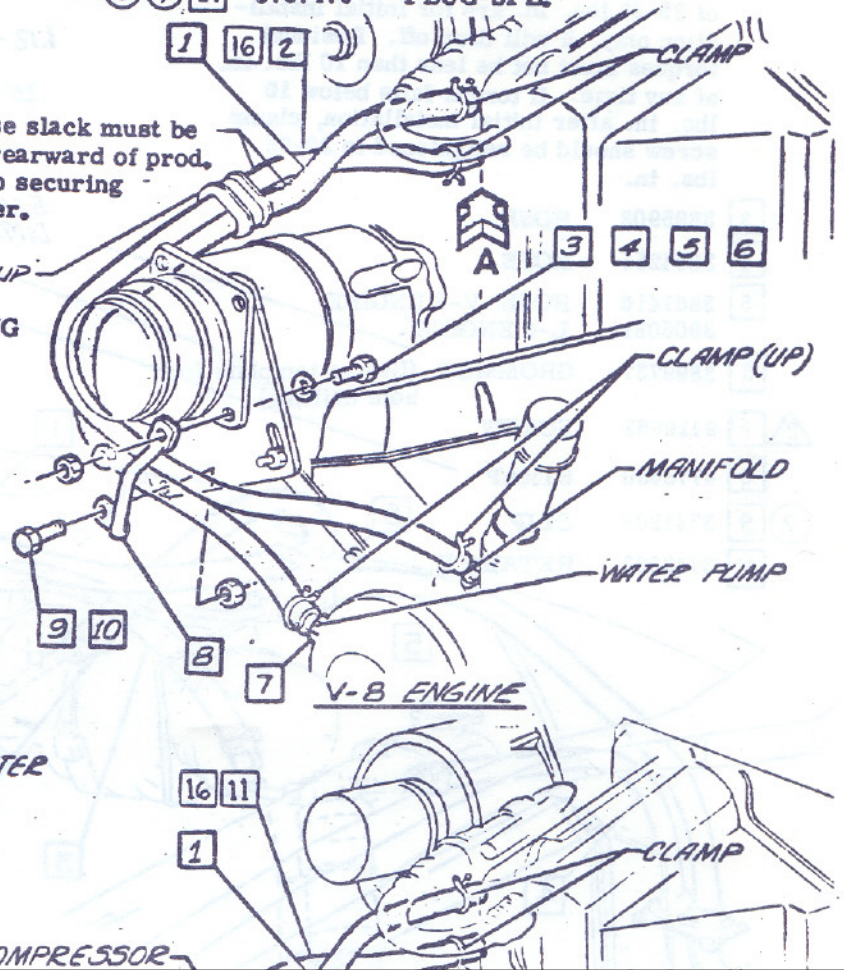
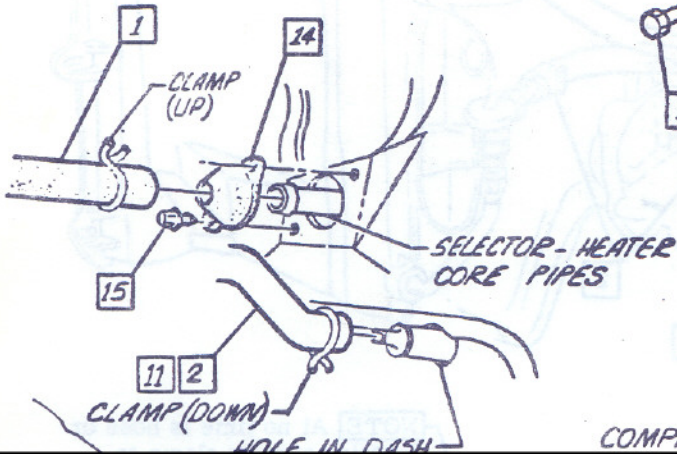

- 1 3902253 HOSE
- 2 3909030 CLAMP

CAUTION Hose clamp screw torques of 35-42 lbs. in. are for initial installation only, & will drop off. Residual torques must not be less than 10 lbs. in. at any time. If torque falls below 10 lbs. in. after initial installation, clamp screw should be retightened to 20-25 lbs. in.

- 3 3895908 HOSE
- 4 3864251 HOSE
- 5 3861416 HOSE V-8 ENGINE
3906081 L-6 ENGINE
- 6 3899737 GROMMET (Use as template for hole drilling)
- 7 9419663 SCREW
- 8 4778650 STRAP
- 9 3741203 CLIP
- 10 3747332 RETAINER

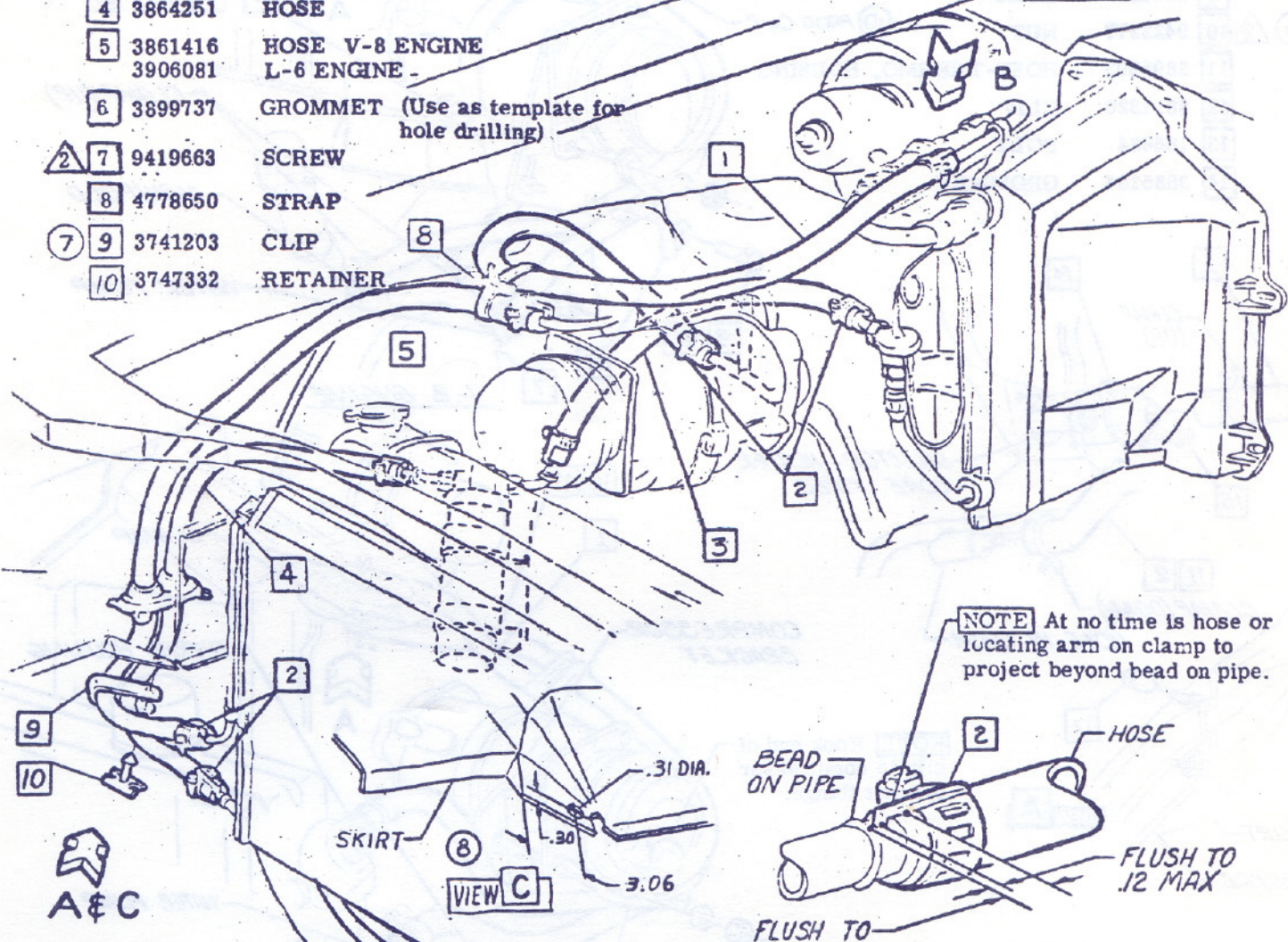
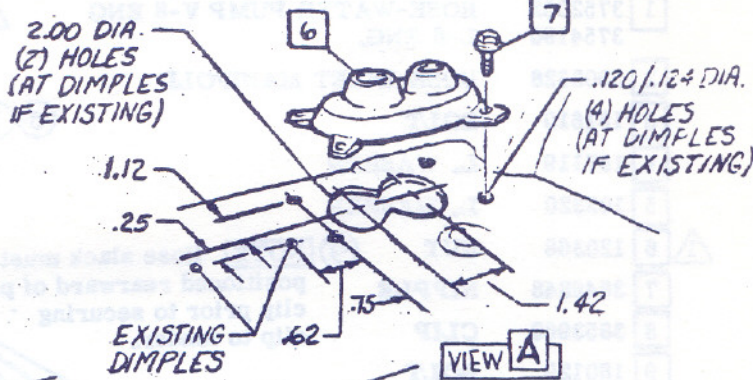

NOTE At no time is hose or locating arm on clamp to project beyond bead on pipe.

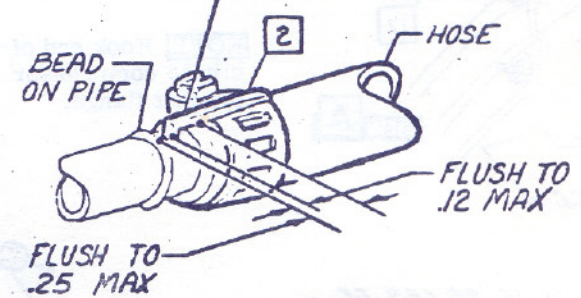

(TYPICAL FOR ALL HOSES)

▲ 35-42 LBS IN — SEE CAUTION NOTE
 ▲ 10-15 LBS IN
 ▲

• CHEVROLET MOTOR DIVISION, GMC •				UPC	DATE	SYM	REVISION RECORD	AUTH.	DR.	CR.
TITLE AIR CONDITIONING-HOSE ROUTING				C60	9-22-67	7	ITEMS 9 & 10 ADDED	54239	67	
						8	VIEW "C" ADDED			CL
MOD 12000 L. D.				D3						
DWG PREL 1-29 BAM REF: Prel. DS L-81387 L-					SPFET					
DATE REL 5-1 CI L- L- L-										

- 1** 3895914 FITTING & MUFFLER ASM
- 2** 3706737 SPL. WASHER
- 3** 103321 L. WASHER
- 1** **4** 120677 BOLT
- 1** **5** 3908066 BRACKET-LOWER
- 2** **6** 3906065 BRACKET-UPPER
- 2** **7** 9421033 SCREW
- 8** **10** OIL-REFRIGERANT (.0063 qts.)

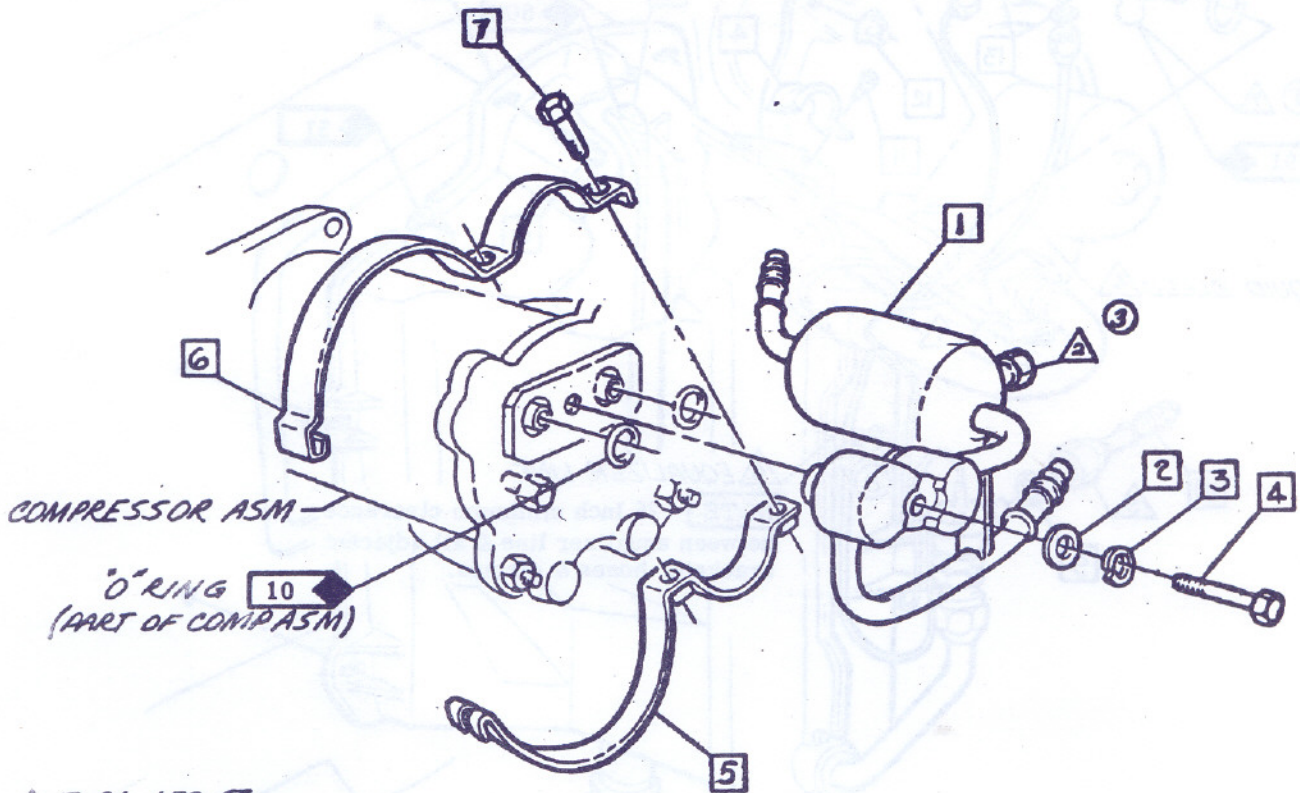

▲ 17-26 LBS FT.
▲ 20-30 LBS IN.
▲

CHEVROLET MOTOR DIVISION, GMC				UPC	DATE	SYM	REVISION RECORD	AUTH.	DR	CK
TITLE CONDITIONING-FITTING & MUFFLER ASM				C60	5-31-66	1	WAS 3859744 BRKT.	78782	DM	
						2	WAS 3859742 BRKT.			
MOD 12000				D2	9-20-66	3	TORQUE ADDED	79106	ER	DF
DWG PREL 1-19 BAW REF: Prel. DZ L- 81387 L-				SHEET						
DATE REL. 3-1 WUB L- L- L-										

- | | | | | | |
|----|---------|----------------|----|---------|---------------------------|
| 1 | 3885185 | TUBE ASM | 2 | 446069 | NUT |
| 2 | 606404 | SPL. WASHER | 3 | 8526645 | GASKET |
| 3 | 3895910 | STUD ASM | 4 | 3140852 | GASKET |
| 4 | 3859062 | CLAMP | 5 | 5910602 | VALVE ASM |
| 5 | 3885183 | EVAPORATOR ASM | 6 | 9419727 | SCREW |
| 6 | 3863393 | SCREW ASM | 7 | 3873914 | BRACKET |
| 7 | 3135649 | CLAMP | 8 | 51 | SEALING COMPOUND (.04 OZ) |
| 8 | 3148473 | HOSE | 9 | 91 | REFRIGERANT (3.75 LBS.) |
| 9 | 8526398 | GASKET | 10 | 3902250 | SEAL |
| 10 | 3878598 | TUBE ASM | 11 | 50N | ADHESIVE (.06 OZ) |
| 11 | 3873950 | SCREW | | | |

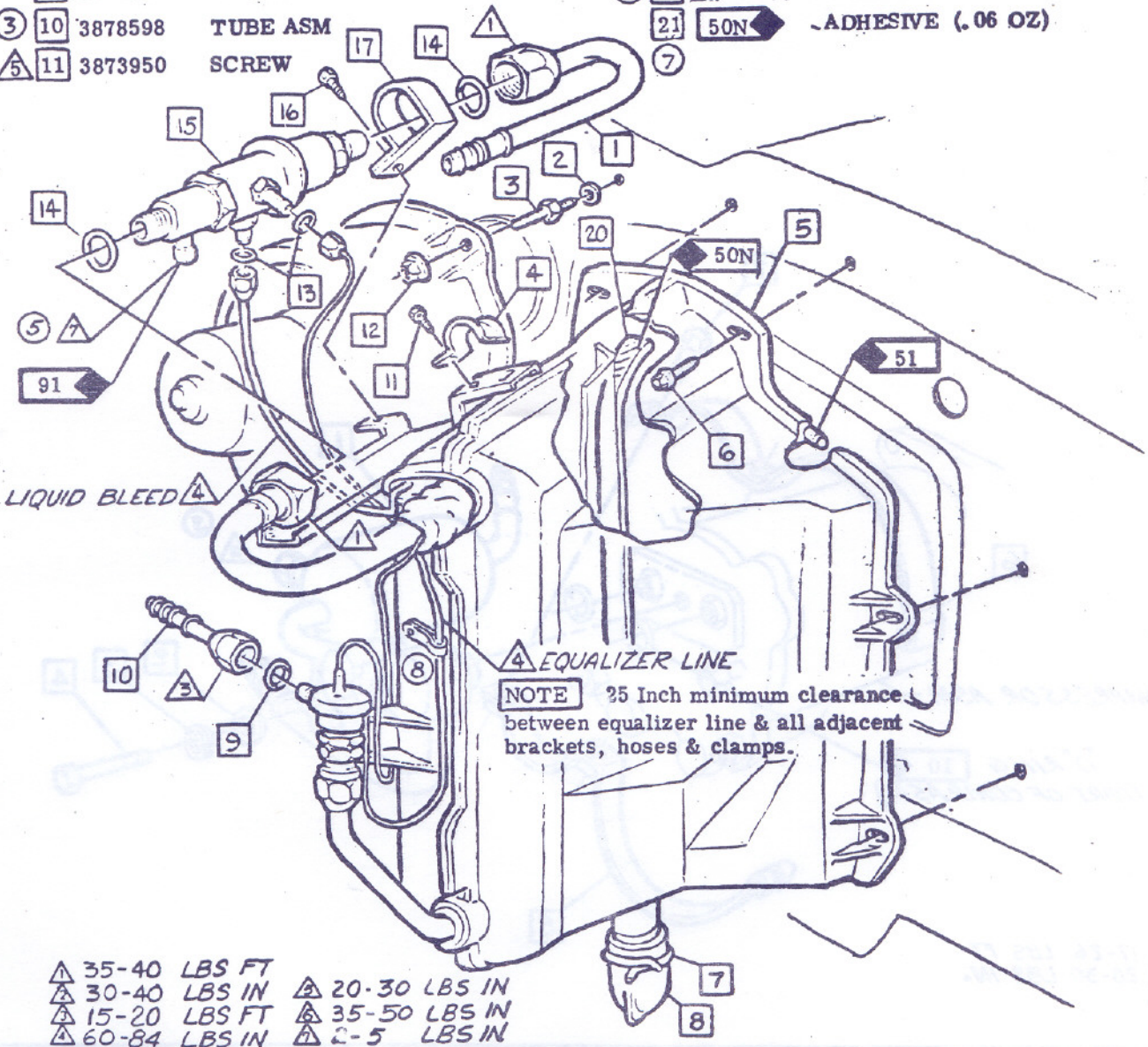

CHEVROLET MOTOR DIVISION, GMC				UPC	DATE	SYM	REVISION RECORD	AUTH.	DR	CK
TITLE AIR CONDITIONING-EVAPORATOR P. O. A. S. T. VALVE				C60	4-12-66	1	ITEM 19 ADDED	72468	WEB	DP
					5-31-66	2	WAS 5910553 VALVE	79216	BI	DF
MOD. 12000 L. D.				D1	6-29-66	3	WAS 3895977 TUBE	76130	WEB	
					9-20-66	4	ITEMS 20, 21, 22 ADDED	79106	ER	DF
DWG PREL 1-15 DATE REC. 3-1				SHEET X	10-3-66	6	TORQUE WAS 30-40 LBS. IN.	82297	EC	DF
					2-8-67	7	3830786 RETAINER RMV'D	85161	GV	
REF: Prel. D1 L-79691 L-						8	RETAINER DWG REV'D			CI

- 1 3854059 BRACE-REAR
- △ 2 179840 BOLT
- 3 103321 L. WASHER
- 4 3854060 SUPPORT-REAR
- △ 5 180126 BOLT
- △ 6 180122 BOLT
- 7 3881805 BRACE-FRONT
- △ 8 120368 NUT
- 9 187119 L. WASHER
- 10 3792420 P. WASHER
- 11 3860404 BOLT
- △ 12 180120 BOLT
- 13 3765135 SPL. WASHER

MANDATORY ASSEMBLY SEQUENCE FOR DETERMINING PROPER SHIM REQUIREMENTS

1. Assemble front mounting bracket to compressor & torque bolts.
2. Assemble rear mounting brackets to compressor & start bolts.
3. Position front & rear brackets relative to supports on engine.
4. Add shims between rear bracket & compressor as required.
5. Torque (Rear bracket to compressor)bolts.

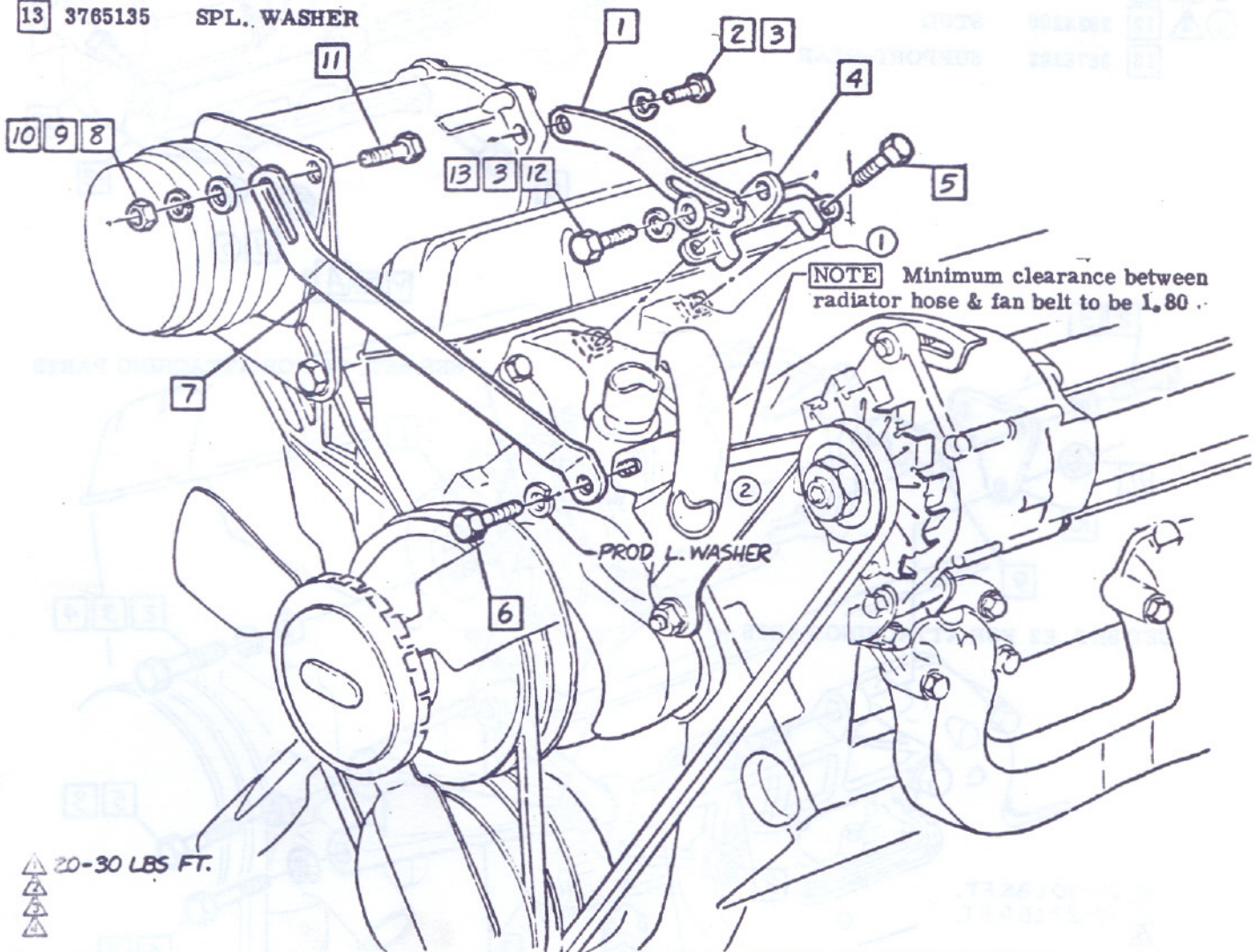

CHEVROLET MOTOR DIVISION, GMC

UPC

DATE SYM

REVISION RECORD

AUTH. DR. CK.

TITLE AL. CONDITIONING-COMPRESSOR MOUNTING	C60	1-4-67	1	CLEARANCE NOTE ADDED	83698	RA	
			2	HOSE DRAWING ADDED			CI
M.C.D. 12000 V-8 ENGINE	C5						
DWG. PREL. 1-17 DATE REL. 3-4	GW MEB	REF. Prel. C3 L-	L-74788 L-	L-79991 L-			
SHEET							

- 1 3841698 BRACKET-FRONT
- ⚠ 2 180122 BOLT
- 3 103321 L. WASHER
- 4 3765135 SPL. WASHER
- ⚠ 5 179848 BOLT
- ⚠ 6 3779940 BOLT
- 7 3841697 SUPPORT-FRONT
- 8 180124 BOLT
- 9 3852876 SHIM-Use as reqd
- 10 3841699 BRACKET-REAR
- Ⓣ ⚠ 11 9422297 NUT
- Ⓣ ⚠ 12 3923299 STUD
- 13 3878222 SUPPORT-REAR

- Ⓣ 14
- ⚠ 15 3841724 BOLT
- 16 3841722 SPACER

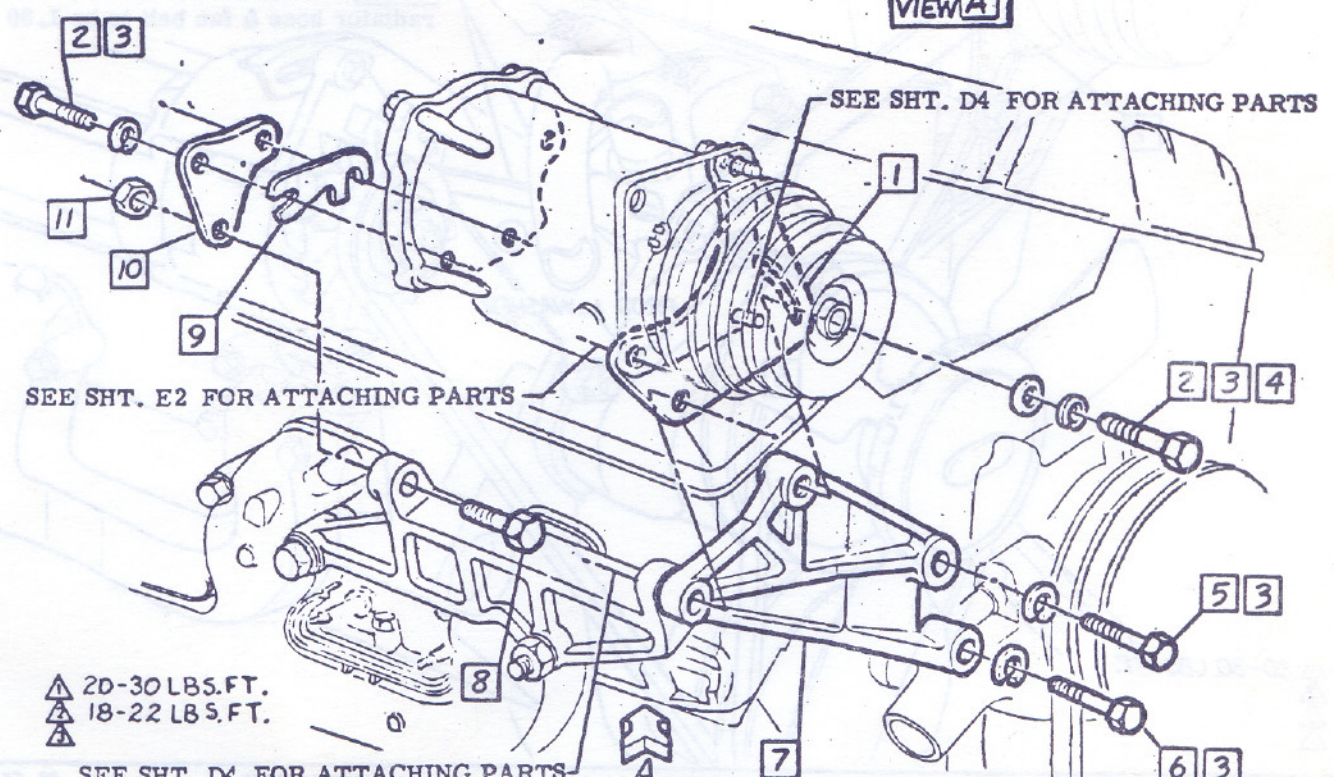
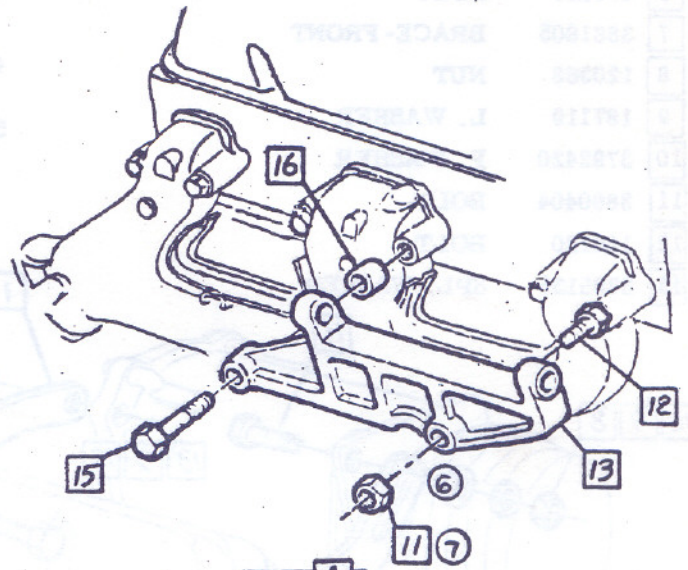

⚠ 20-30 LBS.FT.
⚠ 18-22 LBS.FT.
⚠

SEE SHT. D4 FOR ATTACHING PARTS

CHEV. DIEZEL MOTOR DIVISION, GMC		UPC	DATE	SYM	REVISION RECORD	AUTH.	DR	CK
TITLE AIR CONDITIONING-COMPRESSOR MOUNTING		C60	4-6-67	6	WASHER DWG REMOVED	86329	RT	
				7	SYM. (11) WAS SYM (14)			
M.O.D. 12000 V-8 ENGINE		C4		8	120377 NUT (18-22 LBS FT) RMVD.			
				9	WAS 3909829 STUD			CI
			5-1-67	10	WAS 9422277 NUT	86329	RT	CI
REF: Prel. C4 L-70548 L-81691		ⓧ SHEET						



- 1 3843248 SUPPORT
- ⚠ 2 122138 BOLT
- 3 103321 L. WASHER
- ① ⚠ 4 9422277 NUT
- ⚠ 5 122126 BOLT
- 6 120394 P. WASHER
- 7 3843249 BRACKET-FRONT
- 8 3850581 SHIM-Use as required

- 9 3843250 BRACKET-REAR
- ⚠ 10 180122 BOLT
- 11 3843253 PLATE
- ⚠ 12 444684 BOLT
- ② 13 187119 L. WASHER
- 14 2985954 HIGH TENSION WIRE
- 15 2986300 SPARK PLUG WIRE-CYL NO 4
- 16 2986301 SPARK PLUG WIRE-CYL NO 5
- 17 2985884 SPARK PLUG WIRE-CYL NO 3
- 18 2986302 SPARK PLUG WIRE-CYL NO 6
- 19 2965736 RETAINER
- 20 PRODUCTION PLUG WIRE

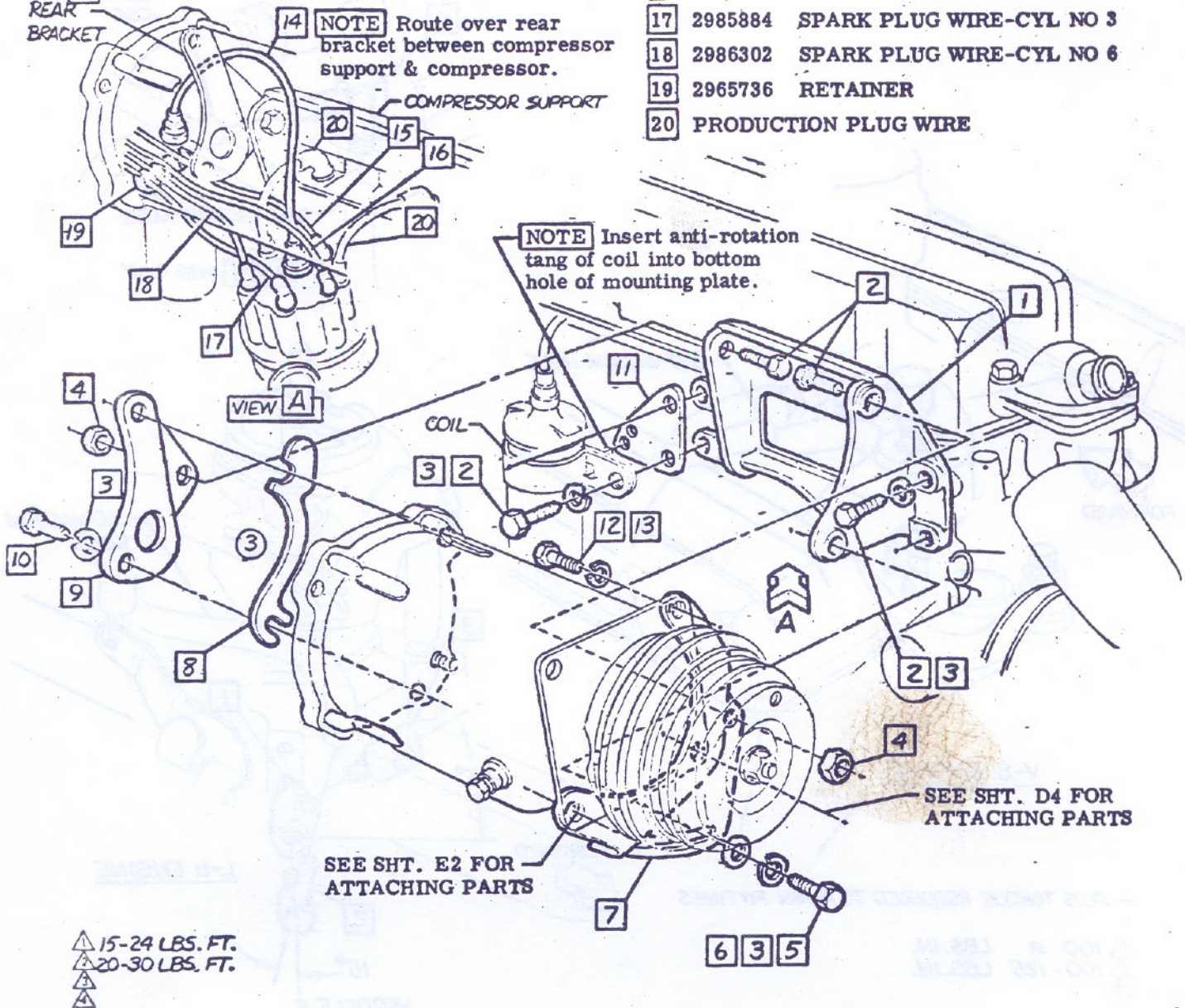

CHEVROLET MOTOR DIVISION, GMC		UPC	DATE	SYM	REVISION RECORD	AUTH.	DR	CK
AIR CONDITIONING-COMPRESSOR MOUNTING		C60	7-5-66	1	WAS 3816622 NUT	77678	6W	
				2	WAS 103320 WASHER			
				3	"SHIM" DRAWING REVISED			
12000 L-6 ENGINE		C3						
DWG PREL 1-14	GW	REF: Prel. C2	L- 70363	L-				
DATE REL. 3-1	WEG	L-	L-	L-				
		SHEET	×					

- ① 1 3873848 TEE
- ① 2 3891523 TEE ASM
- ① 3 7025095 CARB-AIRATOR
- ① 4 3891524 TEE ASM

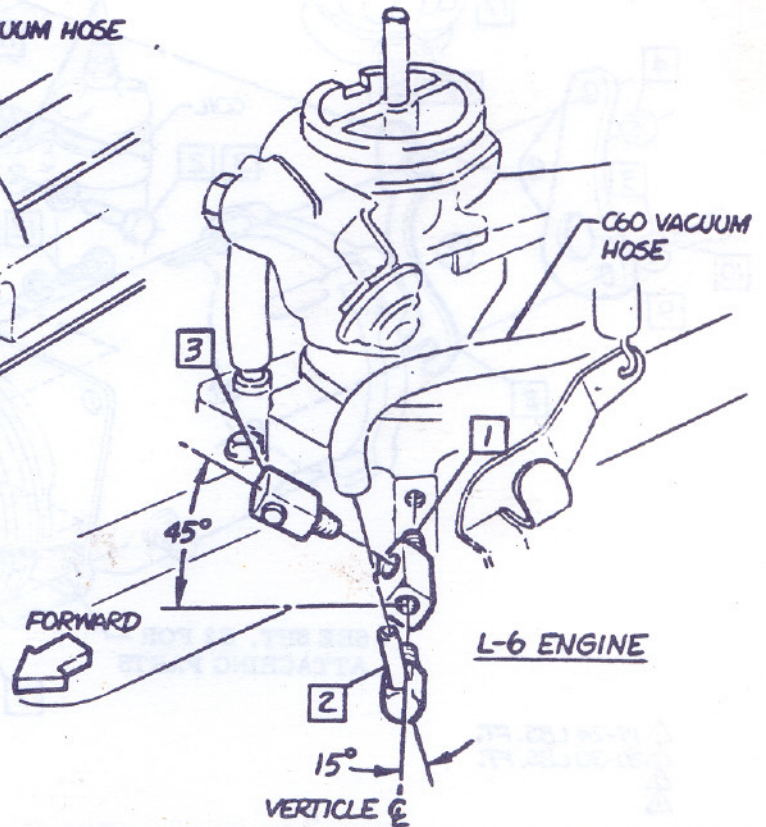
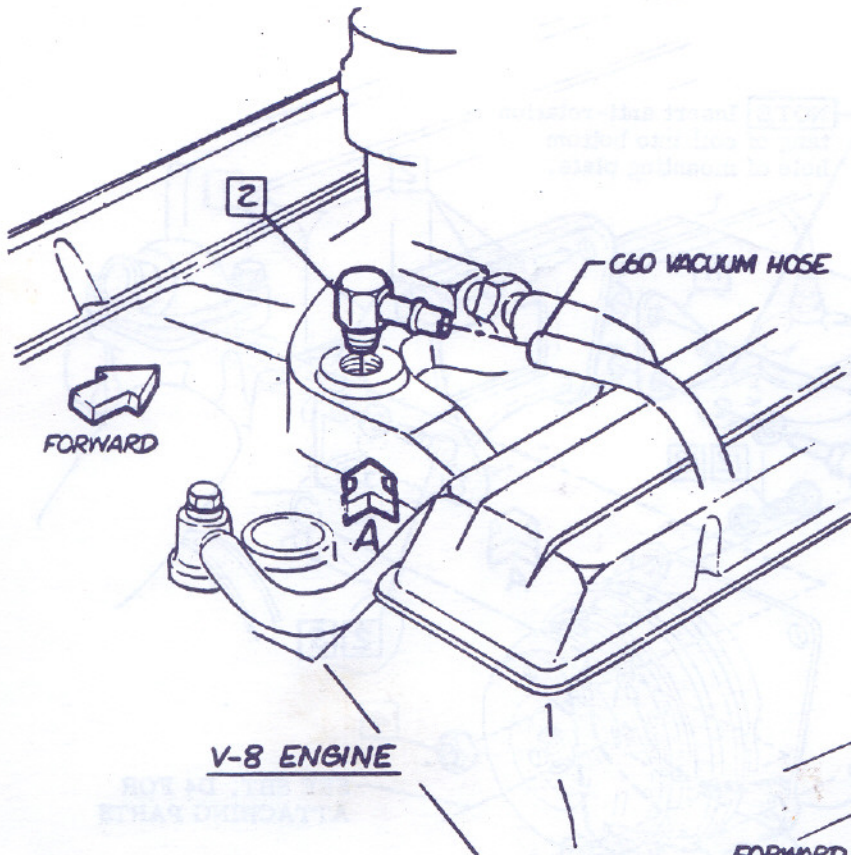
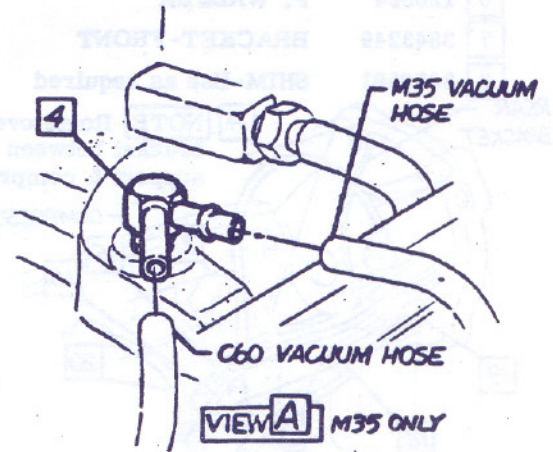

* PLUS TORQUE REQUIRED TO ALIGN FITTINGS

- ▲ 100 * LBS. IN.
- ▲ 100-125 LBS. IN.
- ▲

CHEVROLET MOTOR DIVISION, GMC				UPC	DATE	SYM	REVISION RECORD	AUTH.	DR	CK
TITLE AIR CONDITIONING-CARB AIR BLEED VALVE				C60	10/26/66	1	WAS 7024098 C-AIRATOR	8299	GW	DFI
MOD 12000					C2					
DWG PREL. 1-19	RS	REF: Prel. C5	L-72579	L-79199						
DATE REL. 3-1	WEB	L-	L-	L-						
				X SHEET						



- ① 1 3899771 TUBE ASM
- 2 8526398 O-RING
- 3 3155342 RECEIVER & DEHYDRATOR
- ① 4 3899772 TUBE ASM

- ② 5 9419380 SCREW
- 6 3895918 BRACKET -LOWER
- 7 3902248 BRACKET-UPPER

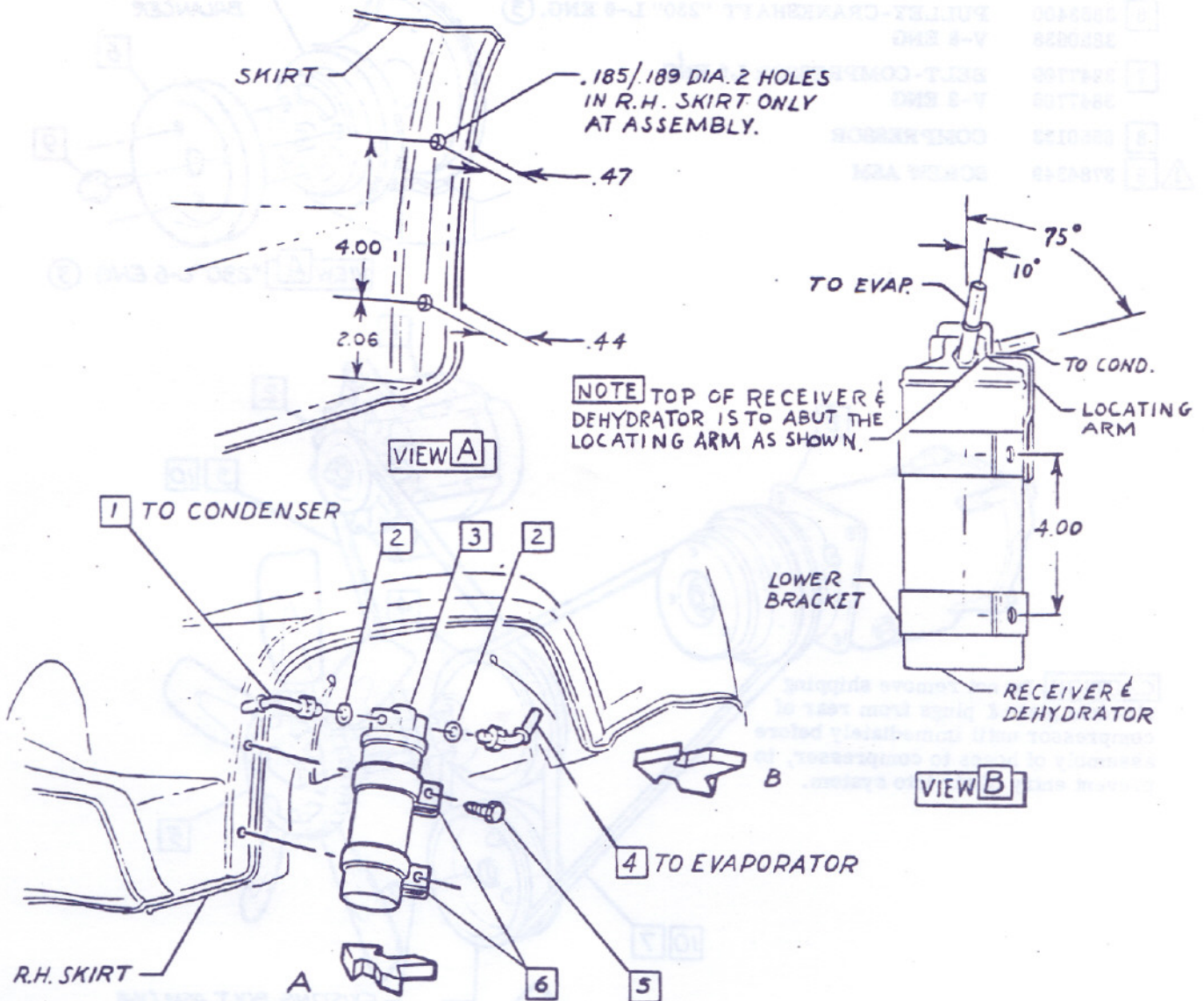

▲ 132-156 LBS. IN.
 ▲ 10-15 LBS. IN.
 ▲

● CHEVROLET MOTOR DIVISION, GMC ●		UPC	DATE	SYM	REVISION RECORD	AUTH.	DR.	F
TITLE RECEIVER & DEHYDRATOR		C 60	4-22-66	1	REDRAWN & REDESIGNED	75525 GM		
MOD 12000			B 2			78035		DF
BY G PREL 1-19 dm	REF: Prel. B2 L-81387 L-							
DATE FEB 3-1 WFB	L- L- L-							



3891775 "F" CAR 12000 SERIES

① 6 3899793 CONDENSER ASM

1 3899747-8 BRACKET L. & R.H.

① 2 3846202 SCREW

3 3784845 NUT

② ② 4 9419303 SCREW

③ 5 9422836 NUT

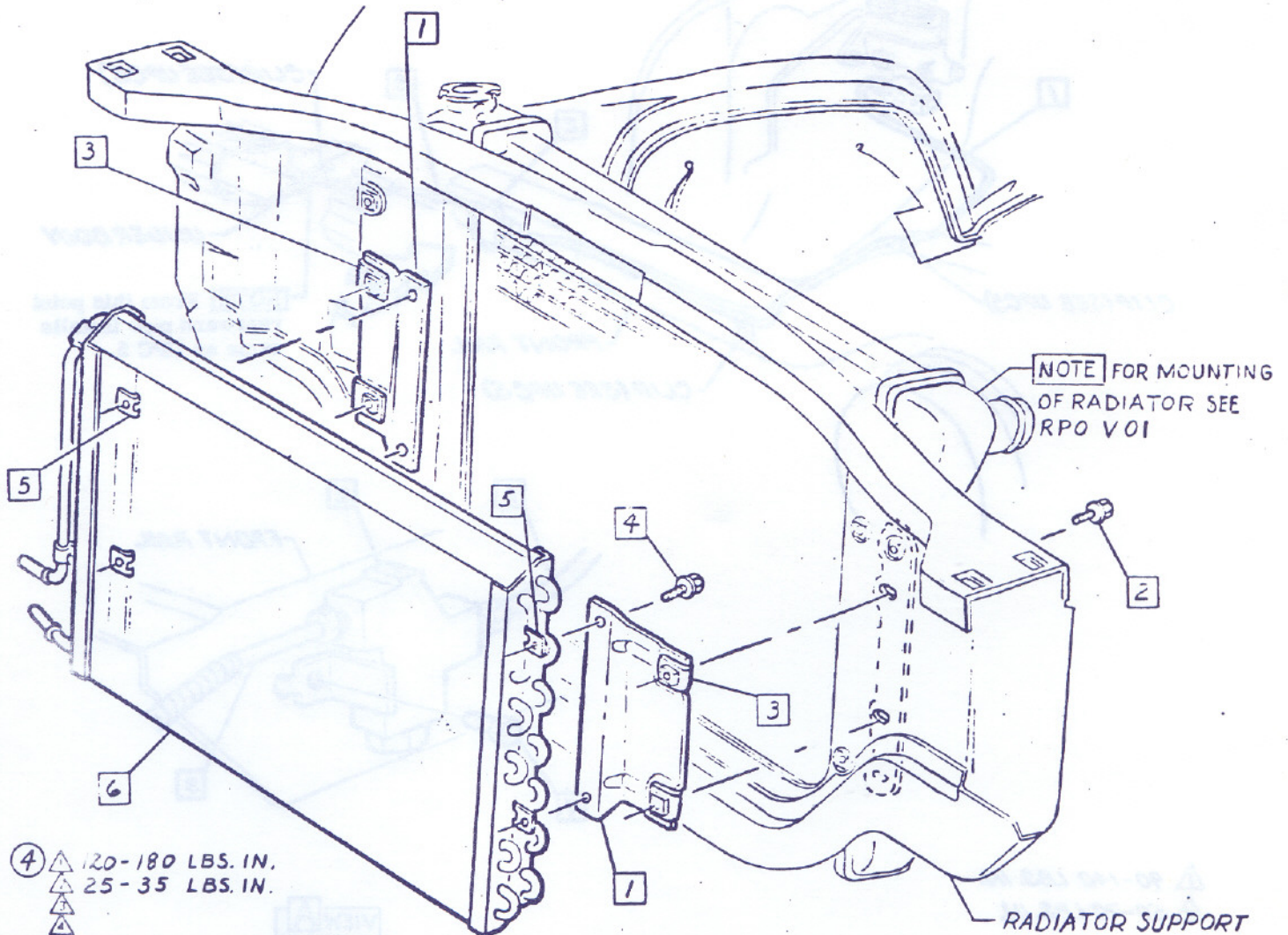

④ ▲ 120-180 LBS. IN.
 ▲ 25-35 LBS. IN.
 ▲
 ▲

CHEVROLET MOTOR DIVISION, GMC		UPC	DATE	SYM	REVISION RECORD	AUTH.	DR	CK
TITLE CONDENSER.		C 60	9-22-66	1	WAS 3891783 COND.	77266	dm	
MOD 12000				2	WAS 9419305 SCREW	75585		
DWC PREL 1-18 dm		B 1		3	WAS 3003556 NUT			
DATE PREL 3-1 WEB				4	TORQUE (1) WAS 70-110 LBS. IN.			DF
REF: Prel. B1 L-81387 L-		SECRET X						
DATE L- L- L-								



- 1 3864640 HOSE L. H.
- ⑦ 2 3917385 STRAP
- △ 3 3841230 SCREW
- 4 3895939 HOSE R. H.
- 5 445347 NUT
- 6 3885180 RETAINER
- ⑥ ④ 7 3906099 ADAPTER

- 8 3855562 SEAL
- 9 3856472 DEFLECTOR
- 10 3885181-2 BEZEL L. & R.H.
- △ 11 9414754 SCREW
- ① △ 12 9414752 SCREW
- ③ ⑤ 13

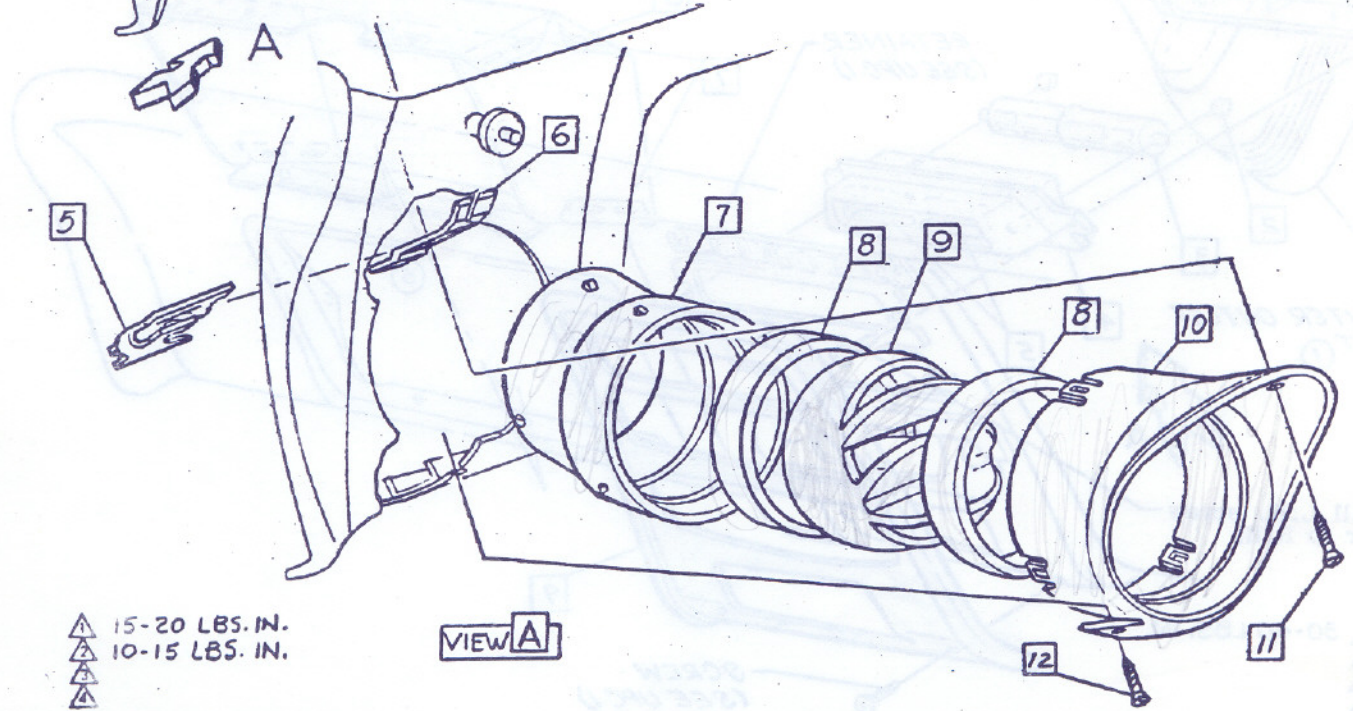
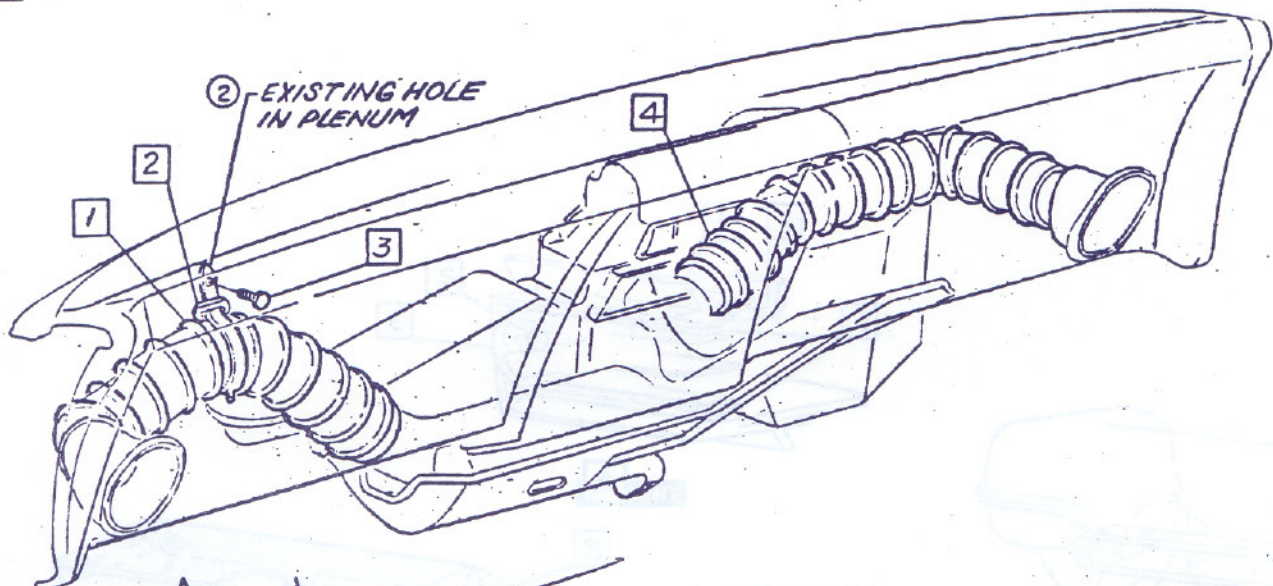

CHEVROLET MOTOR DIVISION, GMC			UPC	DATE	SYM	REVISION RECORD	AUTH.	DR	CK
TITLE	AIR CONDITIONING-SIDE		C60	5-4-66	1	ITEM 12 ADDED	72866	LEB	
	OUTLETS AND HOSES				2	NOLE REF. ADDED			
					3	ITEM 13 ADDED	72805		
MOD	12000		A8	8-8-66	4	WAS 3891237 ADAPTER	77692	DF	
DWG	PREL 1-26			9-20-65	5	3893821 PLATE REMOVED		LEAD DF	
DATE	REL 3-1	DP		1-29-66	6	WAS 3895941 ADAPTER	81182	LEAD DF	
					7	WAS 3895980 STRAP	83415	FM DF	
REF: Prel. A5 L-79478 L-			SHEET						

- 1 3891760 OUTLET ASM
- ⑥ 2 3925719 SPACER
- 3 3891762 VALVE
- 4 3891761 BEZEL

- 5 3891764 SEAL
- ① 6 9424858 SCREW
- ② 7 9985028 STAPLE 10 REQ'D OPT.
- 8 3891766 COMPARTMENT ASM.
- ③ ① 9 3893821 INSTR. PNL. TRIM PLATE

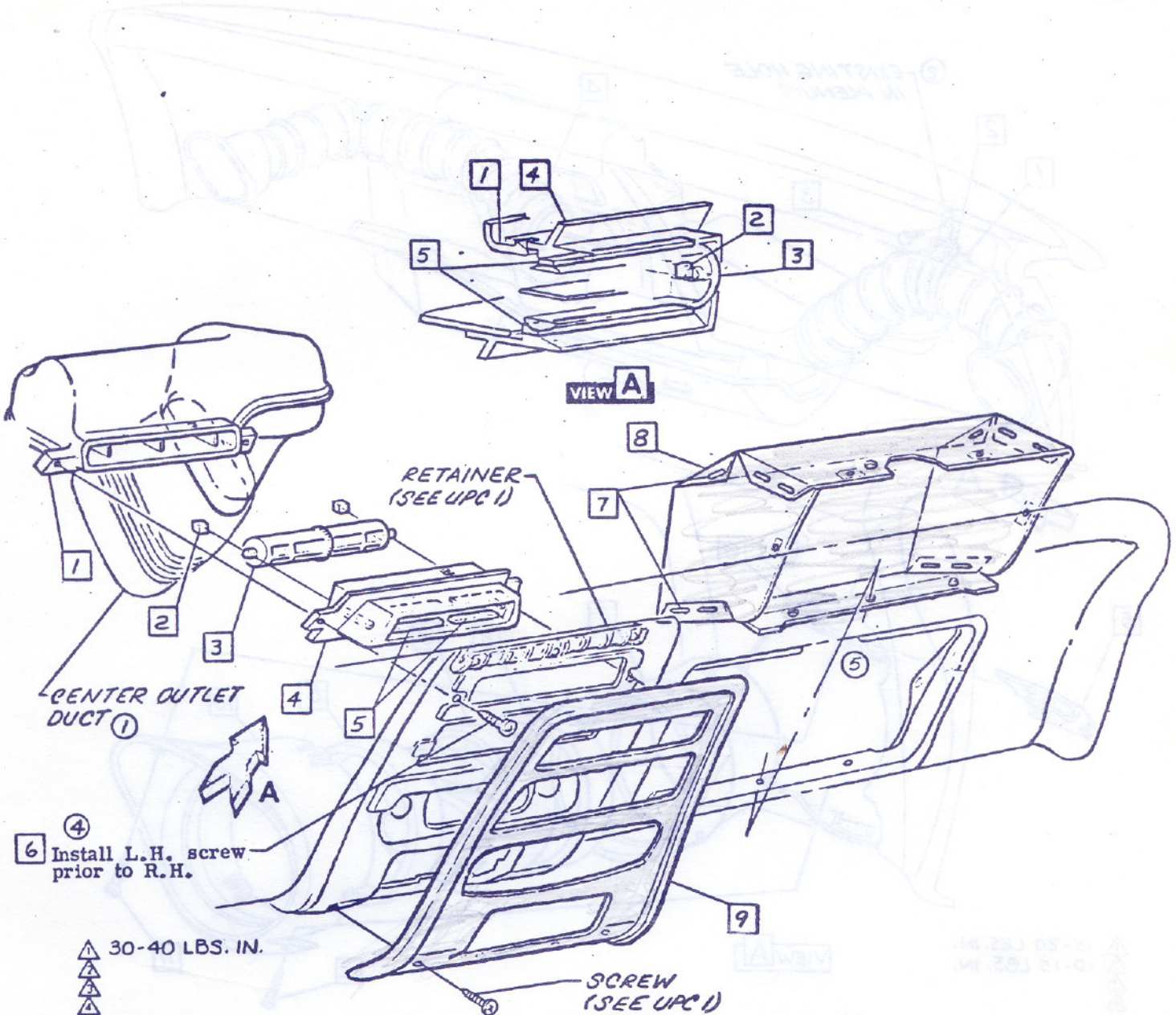

• CHEVROLET MOTOR DIVISION, GMC •				UPC	DATE	SYM	REVISION RECORD	AUTH	DR	CK
CENTER OUTLET ASM & INSTRUMENT PANEL COMPARTMENT				C60	5-4-66	1	"DUCT WAS HOSE"	77212	WEB	DF
					6-7-66	2	9423663 OPT. ADDED	76104	WEB	DF
12000				A7	7-6-66	3	ITEM 9 ADDED	80074	WEB	DP
					9-20-66	4	SCREW INSTALLATION SEQUENCE ADDED	81670	WEB	DF
DWG PREL 1-26 DATE REL 3-1				REF: Prel. RG L-77741 L- L- L-	10-5-66	5	(3) SLOTS REMOVED	81690	PM	DF
					3-8-67	6	WAS 3891763 SPACER	15960	RT	CI
				SHEET						

- | | | |
|---------------------------|---|--|
| ▲ 1 446069 NUT | 7 3902274 DUCT | 12 3895919 OUTLET-DIST
Insert flange into
retainer on air
defroster dist. |
| 2 3889483 GASKET | 8 _____ | |
| 3 3889484 SEAL | ▲ 9 3873950 SCREW | 13 3769610 P. WASHER |
| 4 50D CEMENT-ADH .005 OZ. | 10 3891724 GASKET | 14 3917338 DIST ASM-DEF |
| 50E .04 OZ | 11 3891723 DUCT ASM-DIST
Insert flange under
flange on retainer | 15 3868762 SPL. WASHER |
| 50F .002 OZ (13) | | 16 3902277 OUTLET ASM |
| 5 3889486 DUCT ASM-SEL | | 17 3902331 OUTLET ASM |
| ▲ 6 3863393 SCREW | | 18 3925405 MAT ASM.
DASH PANEL |

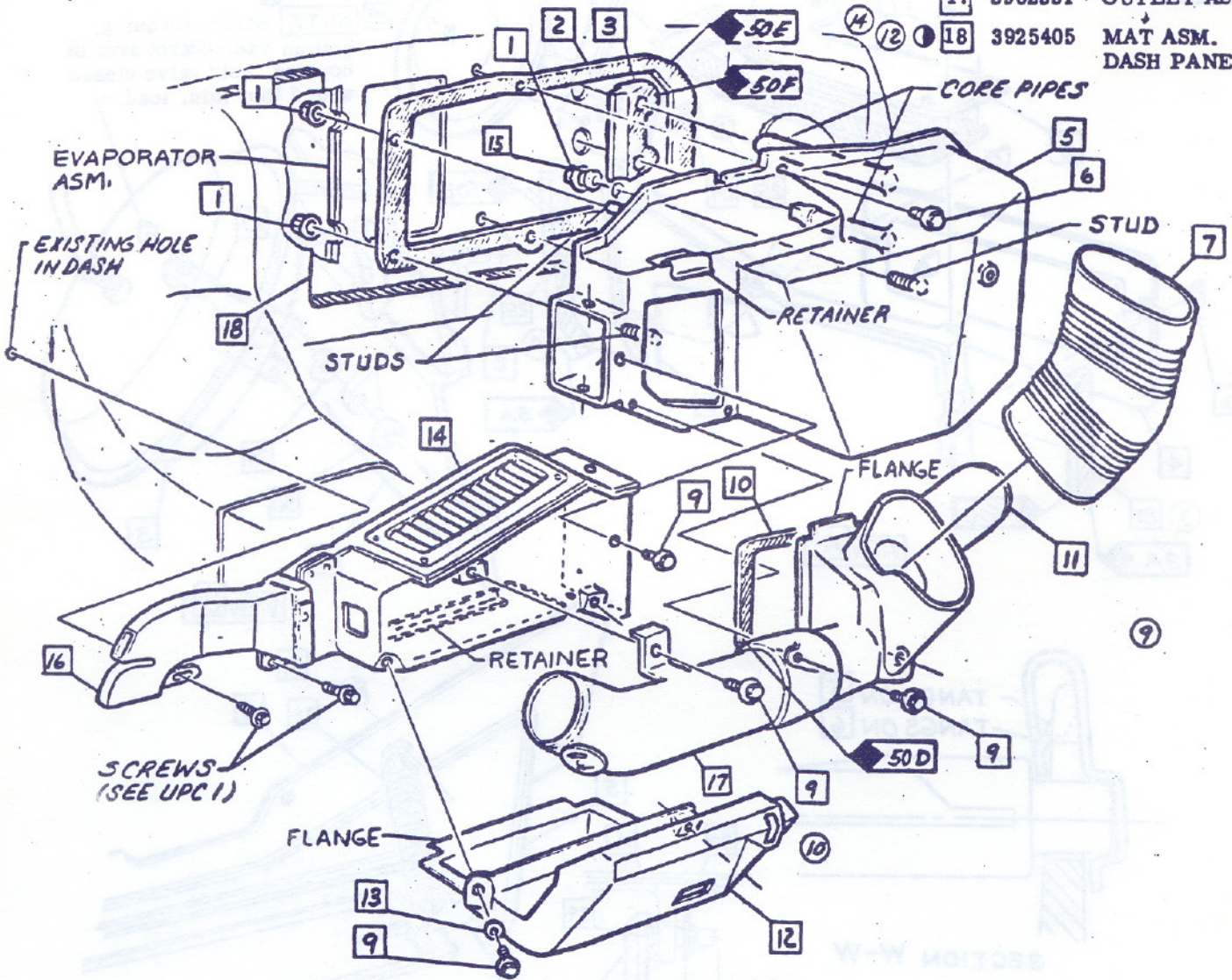

▲ 30-40 LBS. IN.
▲
▲

● CHEVROLET MOTOR DIVISION, GMC ●		UPC	DATE	SYM	REVISION RECORD	AUTH.	DR	CK
TITLE AIR CONDITIONING-SELECTOR & DISTRIBUTORS		C60	5-17-66	9	ITEM 9 REMOVED	76679	WEB	
				10	ITEM 12 REVISED		DF	
MOD 12000		A6	11-29-66	11	WAS 3895768 DISTRIBUTOR	82903	WEB	
				12	ITEM 18 ADDED	82180	DF	
DWG PREL. 1-22 / LEB REF: Prel. A4 L- 80866 L-79691		X SHEET	1-13-67	13	.002 WAS .02		RS	CL
			DATE REL 3-1 / DP L- L- L-	5-3-67	14	WAS 3916675 MAT	84302	RT

- ① 1 9419303 SCREW
- ② 2 3891703 PLATE
- ③ 3 1998927 CONTROL ASM-VACUUM
- ④ 4 3891700 VALVE ASM

- ⑤ 5 3891701 HOUSING-VALVE
- ⑥ 6 3891707 CLIP

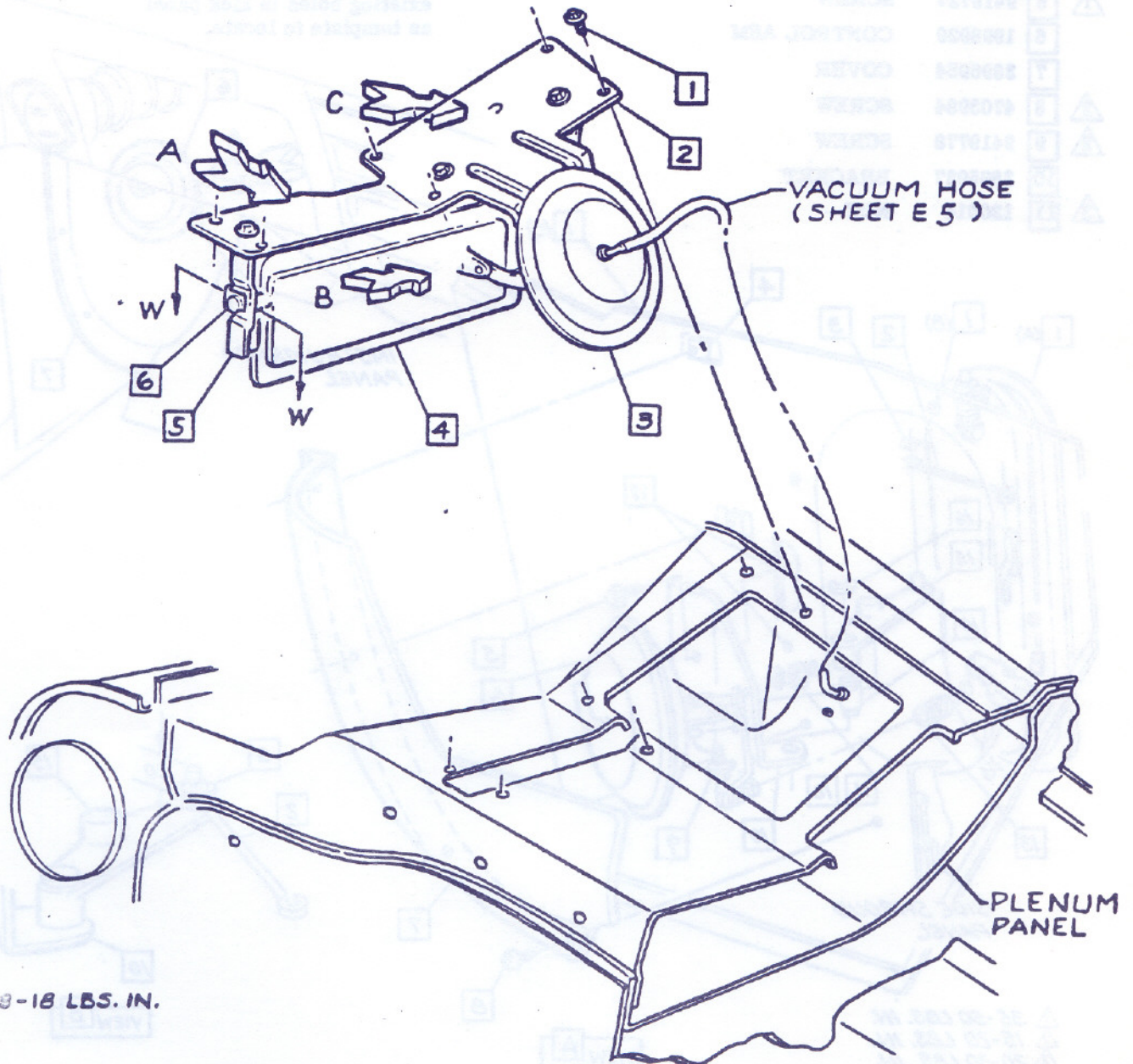

▲ 18-18 LBS. IN.
▲
▲
▲

CHEVROLET MOTOR DIVISION, GMC ©			UPC	DATE	SYM	REVISION RECORD	AUTH	DR	CR
TITLE	AIR CONDITIONING-PLENUM VALVE			C60					
	MOD	12000			A4				
DWG PREL. 12-9		WEB	REF: Prel. A2	L- 79588		L-			
DATE	REL 3-1	DP	L-	L-	L-				
				☒ SHEET					



1 Provided by Fisher Body:

- (A) - Door Asm
- (B) - Screw (4)
- (C) - Kick Panel

- 2 3895929 LINK
- 3 381700 NUT-RETAINER
- 4 3858749 "J" NUT
- 5 9419727 SCREW
- 6 1998929 CONTROL ASM
- 7 3895954 COVER
- 8 4703984 SCREW
- 9 9419778 SCREW
- 10 3895927 BRACKET
- 11 120614 NUT

- 12 138479 L. WASHER
- 13 3895931 SPRING
- 14 3895930 PIN- STAKE SECURELY TO 10
- 15 3895928 ARM
- 16 274574 RETAINER

17 .204/.208 dia (2) holes in side shroud panel. Use existing holes in kick panel as template to locate.

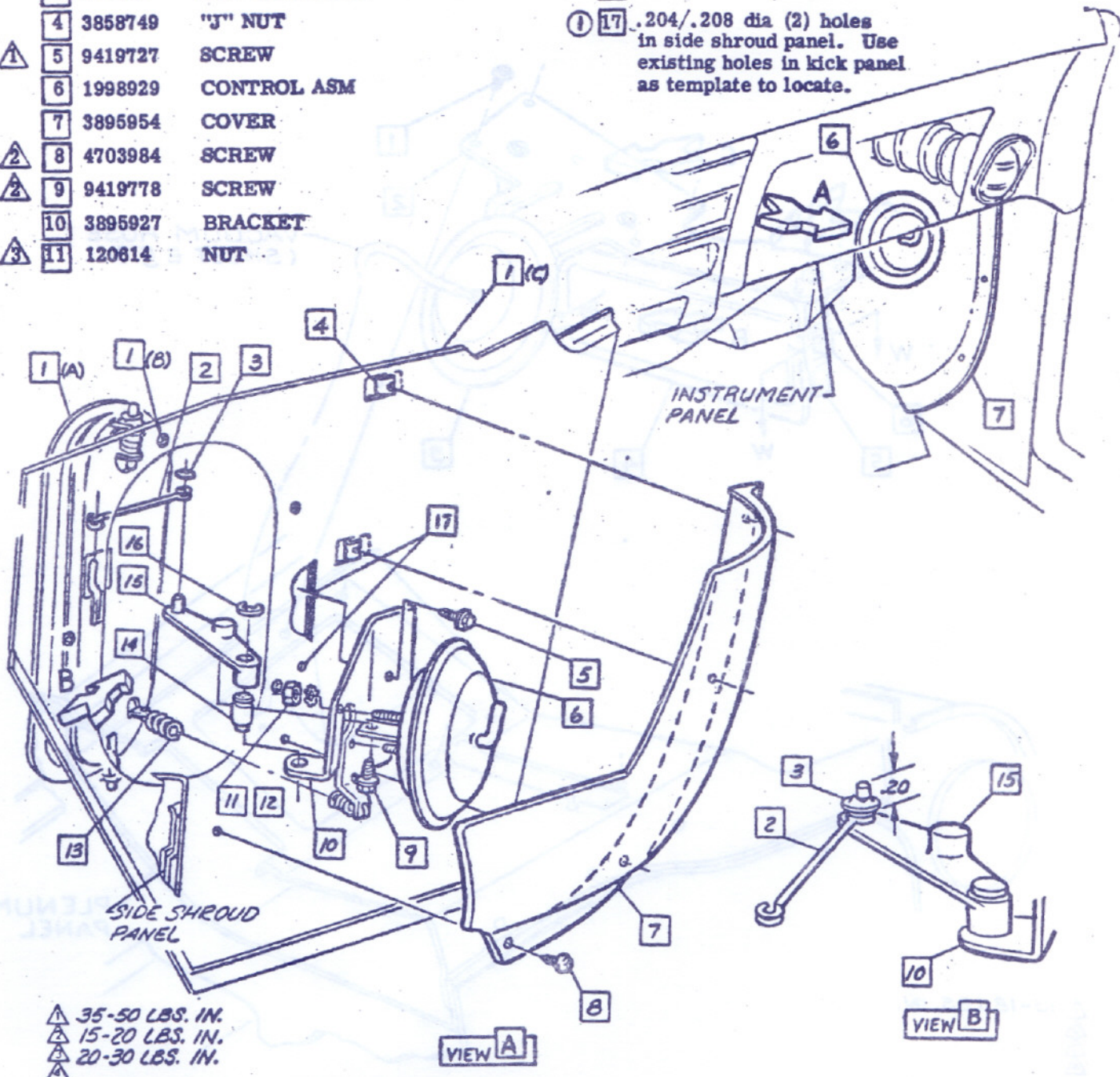

- ▲ 35-50 LBS. IN.
- ▲ 15-20 LBS. IN.
- ▲ 20-30 LBS. IN.

CHEVROLET MOTOR DIVISION, GMC		UPC	DATE	SYN	REVISION RECORD	AUTH	DR	C
AIR CONDITIONING-SIDE SHROUD CONTROL, KICK PANEL & COVER		C60	7-22-66	1	ITEM 17 HOLE NOTE ADDED	72468	WEL	4
			7-5-66	2	"STAKE" NOTE ADDED	80094	WEL	4
MOD 12000		A3						
DWG PREL. 1-28 WEL REF: Prei. A7 L-77742 L-		SHEET						



SHEET	TITLE	SHEET	TITLE
A1	CONTENTS	D1	EVAPORATOR & P.O.A.S.T. VALVE
A2	NON-ILLUSTRATED	D2	FITTING & MUFFLER ASM
A3	SIDE SHROUD CONTROL KICK PNL & COVER	D3	HOSE ROUTING
A4	PLENUM VALVE	D4	HEATER HOSES
A5	PLENUM VALVE	D5	HOSES A/C & HEATER
A6	SELECTOR & DISTRIBUTOR	E1	FRONT WIRING
A7	CENTER OUTLET & INST. PNL COMP	E2	COMP. WIRING BATTERY & CABLES
A8	SIDE OUTLETS & HOSES	E3	CONTROL ASM
④ A9	PRESSURE REGULATOR VALVE	E4	CONTROL CABLES & VAC HOSE ASM
B1	CONDENSER	E5	VAC CONTROL HOSES
B2	RECEIVER & DEHYDRATOR	E6	INST. PANEL WIRING
C1	COMP, FAN, BELT & PULLEYS	E7	INST. PANEL WIRING
C2	CARB AIR BLEED VALVE	E8	WIRING DIAGRAM
C3	COMP. MOUNTING L-6 ENG	E9	TEST PROCEDURE
C4	COMP. MOUNTING V-8 ENG	E10	GEN. SPECS & PROCEDURES
C5	COMP. MOUNTING V-8 ENG		

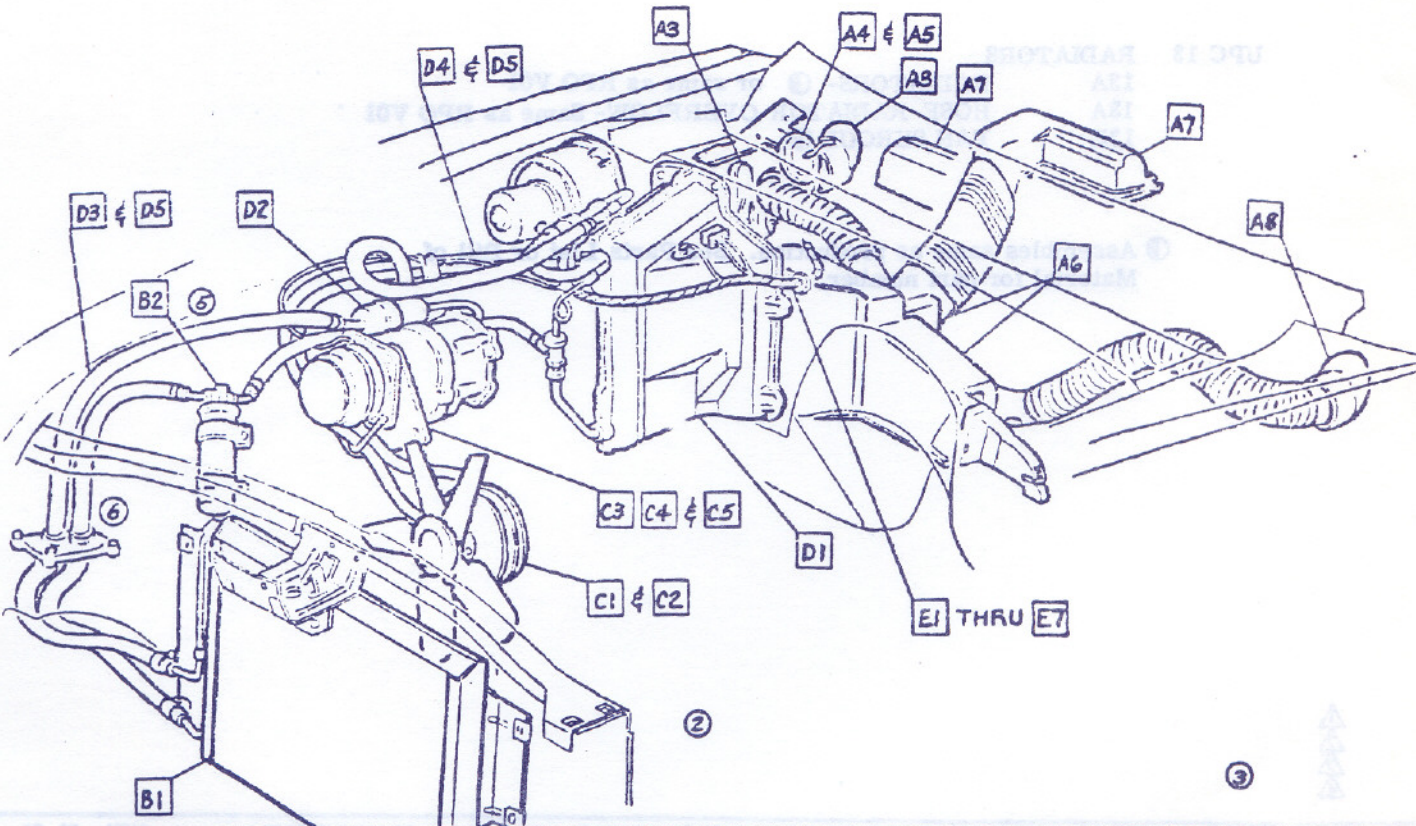

CHEVROLET MOTOR DIVISION, GMC				UFC	DATE	SYM	REVISION RECORD	AUTH	DR	CK
TITLE AIR CONDITIONING-CONTENTS				C60	5-4-66	1	REFRIGERANT MVD TO SHT D1	72168	WEB	
						2	DRAWING ADDED			
M.C.D. 12000				A1	5-18-66	4	"INCOMPLETE" NOTE REMOVED	77115	WEB	DF
						5	SLEEVE ADDED ON HOSE	79251		DF
DWG 2-17 DATE REL 3-1				SHEET X	6-7-66	6	GROMMET ADDED & HOSES REROUTED	79672	WEB	DF